

Register your products and get support at
www.philips.com/welcome

1335 Series

32PFL1335



User Manual

PHILIPS

Contents

1. Announcement	1	7. Connect Devices	17
2. Important Information	2	Interfaces on the back	18
3. Product Introduction	5	Interface on the side	18
Control Panel	5	Connect to PC	19
Remote Control	6	Use of Philips EasyLink	20
Use the Remote Control	7	8. Product Information	21
4. Use the TV	7	Display Resolution Supported	21
Switch to Standby Mode	7	Multimedia	22
Switch the Channel	8	Tuner/Receiver/Transmitter	22
View Connected Devices	9	Remote Control	22
Adjust the Volume	9	Power Supply	22
5. Other Functions	10	TV Mounting Bracket	22
Access the TV Menu	10	Specification	22
Change the Language	10	9. Trouble Shooting	23
Change the Image and Sound Settings	10	Common Troubles	23
Use the Smart P Mode	10	Channel Troubles	23
Adjust the Picture Settings Manually	11	Image Troubles	23
Aspect Ratio	11	Audio Troubles	24
Use the Smart Sound	12	HDMI Connection	24
Change the Other Settings	12	Computer Connection	25
Use the Sleep Timer	13	Contact Us	25
Use the Lock Function	13		
Set or Change the Password	13		
Lock/Unlock Channels	14		
Play USB Media	14		
6. Set up the Channels	16		
Auto Scan	17		
Manual Scan	17		
Channel Edit	17		

1. Announcement

2013 © Koninklijke Philips Electronics N.V. All rights reserved.

The product specifications are subject to change without further notice. All trademarks shall remain the property of Koninklijke Philips Electronics N.V or their respective owners. TP VISION NETHERLANDS B.V.reserves the right to change the specifications of the product at any time with no obligation to apply such changes to products already shipped. The information provided in this Manual is sufficient to explain the designed purpose of this product. If you want to use this product or its any module or program for any purpose other than the designed one, please confirm the effectiveness and appropriateness first. TP VISION NETHERLANDS B.V. warrants that the information provided in this Manual does not infringe any American patent, without making any other expressed or implied warranty. TP VISION NETHERLANDS B.V. shall not be held reliable for any mistake in this Manual or any problem arising from this Manual. TP VISION NETHERLANDS B.V. will correct the mistakes reported by users within the

shortest time and post them on its support website.

Pixel

This LED TV provides a high pixel. Its effective pixel reaches 99.999% or higher, but dark or bright spots (red, green or blue) may still appear on the screen. This is a structural property of LED screen (within the limit of general industry standards), not a fault.

Warranty

No user is allowed to replace any component. Do not open or remove the back housing of the TV to expose the inside. Repairs should be referred to Philips customer service center and official repair store, or both the expressed and implied warranty will be void. All operations that are prohibited expressly and all adjustment or assembly steps that are not recommended or authorized in this Manual shall fall out of the scope of the warranty.

Copyright

All other registered and unregistered trademarks shall remain the property of their owner.

® Kensington and Micro Saver are the trademarks registered in America and registered or being registered in other countries and regions by ACCO World Corporation.

Copyright of the software of this product: © The Free Type Project (www.freetyp.org).

HDMI™
HIGH-DEFINITION MULTIMEDIA INTERFACE

HDMI™

HIGH-DEFINITION MULTIMEDIA INTERFACE

The name "HDMI", HDMI logo and high-definition multimedia interface are the trademarks or registered trademarks of HDMI Licensing LLC. The name "Philips" and the Philips shield mark are the registered trademarks of Koninklijke Philips Electronics N.V and should not be used by any person without the authorization of Koninklijke Philips Electronics N.V.

2. Important Information

Please read and understand this Manual carefully before using this TV. Damages caused by failure to follow this Manual shall fall out of the scope of the warranty.

Safety

Danger! Electric shock or fire!

- This TV is not allowed to contact water or rain. Do not put any liquid container (like vase) beside the TV. If any liquid is splashed into the TV or onto the TV surface, please disconnect the power immediately and contact Philips customer service center for an inspection.
- Do not put the TV, remote control or battery beside any open fire or other heat sources (including direct sunlight). Please always keep the lit candles and other open fires away from the TV, remote control and battery to prevent the flame spreading.



- Do not insert any object into the ventilation hole or any other opening of the TV.
 - Make sure the power cord is not strained when turning the TV, or the power connection could get loose to produce sparks.
- Danger! Short circuit or fire!
- Do not expose the remote

control or battery to water, rain or an overheated environment.

- Do not tension the inserted power plug, or it could get loose to product sparks or cause a fire.

Danger! Personal injury or product damage!

- The TV is more than 25kg in weight and needs two persons to carry.
- To install the TV onto the base, please use the attached base only. The base should be fixed to the TV reliably. The TV should be put on a flat horizontal surface that can bear the total weight of the TV and base.
- To install the TV into the wall, please use a hanging bracket that can bear the weight of the TV. Fix the hanging bracket to a wall that can bear the total weight of the TV and hanging bracket.

TP VISION NETHERLANDS B.V. shall not be held liable for any accident, personal injury or loss caused by improper installation.

Danger! Child hurt!

Please follow the instructions below to avoid the TV falling down to hurt your child:

- Do not put the TV on a surface covered with an unsecured cloth or any other material.
- Make sure the TV is put within the surface edges.
- If you put the TV on a high furniture (like bookcase), please fix both the TV and furniture to a wall or any other appropriate support.
- Let your child know the possible dangers caused by climbing the furniture to touch the TV.

Danger! Do not eat the battery!

- The TV and remote control contain the batteries in a coin size which could be accidentally eaten. Please make sure the batteries are kept beyond the reach of your child.

Danger! Overheating!

- Do not install the TV in a confined space. Leave at least 4 inches or 10cm around the TV for the purpose of ventilation. Make sure the curtain or other objects can not shield the ventilation hole of the TV.

Danger! Do not damage the TV!

- Before connecting the TV to the power socket, please make sure the power voltage conforms to the voltage values printed on the back of the TV. In case of

any difference, do not connect the TV such power socket.

Danger! Personal injury fire or power cord damage!

- Do not allow the TV or any other object to lie on the power cord.
- Make sure you can always touch the power cord so that you can easily disconnect it from the TV when necessary.
- When disconnecting the power cord, please hold the power plug rather than pull the power cord.
- Disconnect the TV from the power socket and antenna before the thunderstorm occurs. In case of thunderstorm, please do not touch any part of the TV, power cord or antenna.

Danger! Hearing impairment!

- Do not use the earphone or headphone at a high volume or for a long time.

Low temperature!

- If the TV has been transported under a temperature lower than 5°C, please open its package, and then do not connect the TV to the power socket until it gets used to the room temperature.

Screen Maintenance

- Avoid using static images. A static image will stay on the

screen for long, like screen menu, black bar and time display.

If you have to use any static image, please reduce the contrast and brightness of the screen to prevent damage.

- Remove the power plug before cleaning the TV.
- Wipe the TV and frame with a wet soft cloth rather than alcohol, chemicals or household detergent.
- Be careful not to damage the screen! Do not use any object to touch, push, rub or tap the screen.
- Wipe the water drops (if any) away immediately to avoid deformation and color fading.

Disposal of Used TV and Battery



This TV is made of recyclable high-performance materials and components.



If the TV carries a wheeled bin mark with a cross, it complies with the EU Directive 2002/96/EC.

Please learn your local separate collection system for electronic and electrical products.

Obey your local regulations not to throw the used TV into the general household waste.

Disposing of the used TV properly can avoid causing negative impacts to the environment and human health.



As stipulated in EU Directive 2006/66/EC, battery should not be disposed of as general household waste in Europe.

Always abide by your local regulations on disposal of batteries.

Recycling of used batteries can prevent negative impacts on the environment and human health caused by hazardous materials contained in the batteries.

3. Product Introduction

Thanks for purchasing a Philips TV!
To get the best technical support from Philips, please register your TV on the following website:
www.philips.com/welcome.

Control Panel

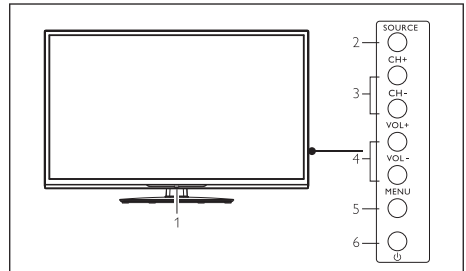

1. Indicator/Remote Control Sensor
2. Source : display the list of signal sources.
3. CH+/- : switch to the previous/next channel.
4. VolL +/- : increase/reduce the volume.
5. Menu : turn on/off the main menu.
6.  : turn on/off the TV; to cut off power supply, please unplug the power cable.

Remote Control

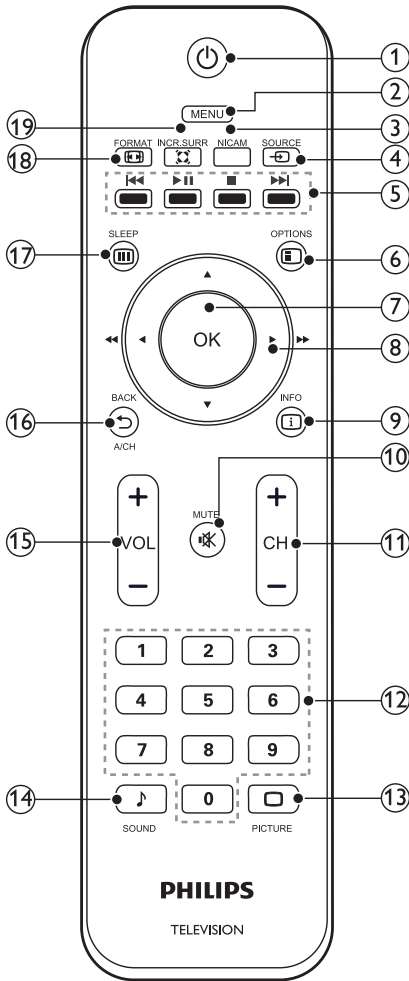

- ① **Power/Standby** button
 - After power-up, press it to turn on the TV;
 - Press it again to switch to standby mode.
- ② **Menu**
Turn on /off the menu.

- ③ **NICAM**
Switch between sound effects (only available for TV signal sources that support NICAM function).
- ④ **Source**
Select an input source for the TV.
- ⑤ **Playback** buttons
Shortcut keys in USB mode: previous, start/pause, stop, next.
- ⑥ **Options**
Access the options related to the current activity.
- ⑦ **OK**
 - In menu mode: confirm the input or selection
 - In USB mode: play/pause.
- ⑧ **Navigation** keys
 - In menu mode: navigate the menu.
 - In USB mode: press **◀▶** to search forward or backward while playing music or video files.
- ⑨ **Info**
Display the program information when available.
- ⑩ **Mute**
Mute or unmute the sound.
- ⑪ **CH +/-**
Switch to the previous/next channel in TV mode.

- ⑫ **Numeric keys (0~9)**
Select a channel or value.
- ⑬ **Smart P**
Switch to the preset image mode.
- ⑭ **Smart S**
Switch to the preset audio mode.
- ⑮ **Volume +/-**
Increase/reduce the volume.
- ⑯ **Return / CH Switch**
Return to the previous channel.
- ⑰ **Sleep**
Switch the TV to the standby mode when the preset time is out.
- ⑱ **FORMAT**
Select the aspect ratio of image.
- ⑲ **Incredible Surround**
Enable or disable the virtual surround audio effect.

Use the Remote Control

When using the remote control, please aim the remote control transmitter at the remote sensor on the TV. Make sure no obstacles stay between the remote control and TV.

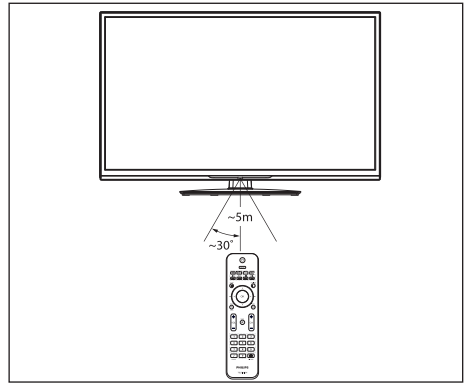

4. Use the TV

The basic operations are described in this section.

Switch to Standby Mode

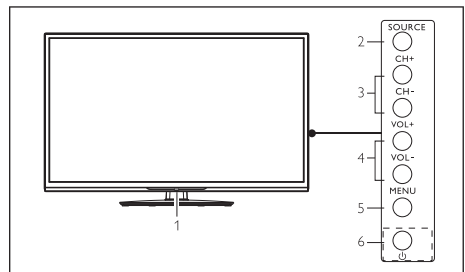

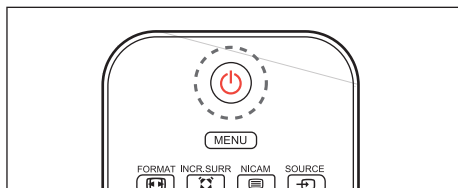

Switch the TV on

- If the indicator is not lit, please plug the power cord into the power socket.
- press the  (Power/Standby) key on the remote control or the power key on the side panel of the TV.

Switch TV to standby

- Press the  (Power/Standby) key on the remote control.



Tips:

- The TV still consumes a little power in standby mode. If you will not use the TV for long, please unplug the TV's power cord.

Switch the Channel

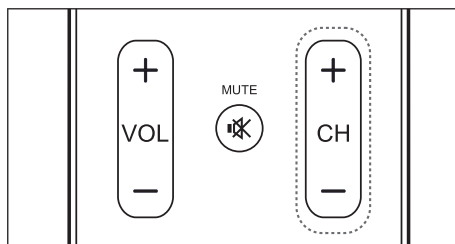
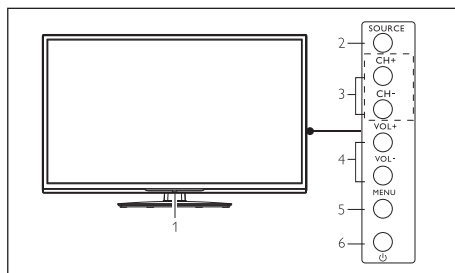

- Press the **CH** +/-key on the remote control or **CH** +/-key on the side panel of the TV.
- Choose a channel using the numeric keys on the remote control.

View Connected Devices



Note:

- Please turn on the external device connected to the TV before selecting the signal source.

Use the Source Key

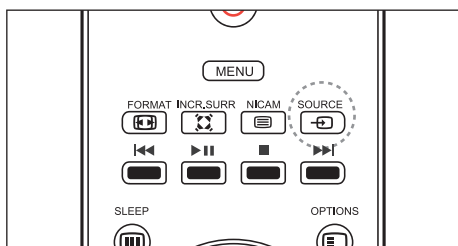

1. Press the key.
↳ The list of signal sources appears.
2. Press to choose a device.
3. Press the OK key to select it.
↳ The TV is switched to the selected signal source.

Adjust the Volume

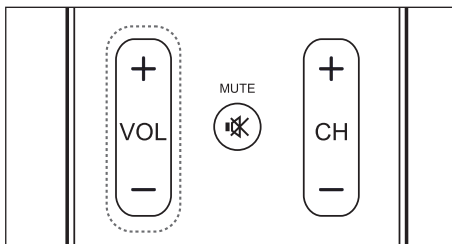
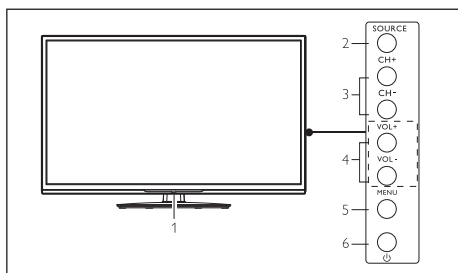

Increase or reduce the volume:

- Press the **Volume** +/- key on the side panel of the TV or on the remote control.

Mute or unmute the sound:

- Press the key to disable audio output.
- Press the key again to unmute the sound output.

5. Other Functions

Access the TV Menu

You can enter the menu to set up the channel, change settings on image and sound and access other functions.

1. Press the Menu key.
↳ The menu is displayed.

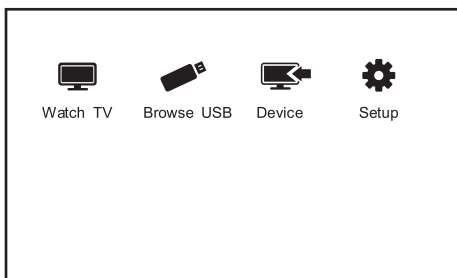

2. Select the following options and press the OK key:
 - [Watch TV]: when other signal sources are selected, you can select this option to switch to the TV program.
 - [Browse USB]: view the photos and play the music and video files from the USB storage device.
 - [Device]: display the devices connected to the TV.
 - [Setup]: change the image, sound and other settings.

Change the Language

You can change the menu language.

Change the menu language:

1. Press the Menu key.
2. Select [Setup] → [Options] → [Menu Language], and then press **▶** to enter.
3. Select a language.

Change the Image and Sound Settings

You can use the predefined image and sound settings or change the settings manually.



Note:

- When watching the TV or a connected device, you can press the **□** key or **♪** key to enter the image and sound settings directly.

Use the Smart P Mode

You can use the predefined image settings.

1. Press the **□** key.
2. Select one of the following options and then press the OK key:
 - [Bright]: increase the image contrast and definition.

- [Standard]: adjust the image settings to fit most video sources and types.
- [Soft]: adjust the image softness.
- [User]: use the user-defined image settings.
- [Color Temperature]: adjust the overall color temperature of the image.
- [Definition]: adjust the image definition (0~100).
- [Reduce Noise]: filter and reduce the noise in the image.
- [Tone]: adjust the color balance of the image settings (0~100).

Adjust the Picture Settings Manually

1. Press the Menu key.
2. Select [Setup]→[Picture], and then press ► to enter.
3. Select one of the following options and then press ► to enter:

- [Smart Picture]: select the predefined image settings.
- [Contrast]: adjust the backlight and increase the difference in backlight intensity between the bright area and dark area (0~100).
- [Brightness]: adjust the light intensity and fineness of the dark area (0~100).
- [Saturation]: adjust the color saturation (0~100).
- [Aspect Ratio]: adjust the aspect ratio of the image.

Change the Aspect Ratio

1. Press the  key.
2. Press ▲▼ to select an image format and then press the OK key.

Aspect Ratio

You can select from the following image formats.

 Note:

- Some of the image formats may not be available for some signal sources.



[Wide Screen]: adjust the aspect ratio from standard to wide-screen.



[4:3]: switch to the standard aspect ratio of 4:3.



[Zoom in Subtitle]: display the image in 4:3 format, zoom in the subtitles to fit the width of the screen, but part of the image will be cut off on the top.



[16:9]: adjust the aspect ratio from 4:3 to 16:9.

Use the Smart Sound

You can use the predefined sound settings.

1. Press the  key.
2. Select one of the following options and then press the OK key.
 - [Standard]: suitable for most environments and signal sources.
 - [Music]: suitable for music files.
 - [Film]: suitable for video files.
 - [User]: use the user-defined sound settings.

Adjust the Sound Settings Manually

1. Press the Menu key.
2. Select [Setup] → [Sound], and then press ► to enter.

3. Select one of the following options and then press ►:
 - [Smart Sound]: select the predefined sound settings.
 - [Bass]: adjust the bass (0~100).
 - [Treble]: adjust the treble (0~100).
 - [Auto Adjust]: suppress sudden change in volume when switching the channel.
 - [Balance]: adjust the balance between the left speaker and right speaker.
 - [Virtual Surround]: enable or disable the virtual surround effect.

Change the Other Settings

1. Press the Menu key.
2. Select [Setup] → [Options], and then press ► to enter.
3. Select one of the following options and then press ► to enter:
 - [Menu Language]: change the menu language.
 - [Menu Timeout]: set the time for displaying menu to 15s/30s/45s/60s.
 - [Menu Transparency]: change the menu transparency (0~100).

- [Blue Screen]: enable or disable the blue screen display function.
- [Sleep Timer]: set the time period before the TV is switched to standby mode (0~180 min).
- [Dynamic Backlight]: turn on/off the dynamic backlight (this optional function may vary depending on the actual products).
- [System Reset]: restore the image and sound settings to the factory default settings (the channel settings will not be reset).

the preset time or reset the sleep timer in the countdown process.

1. Press the Menu key.
2. Select [Setup] → [Options] → [Sleep Timer].
 - ↳ The sleep timer will be displayed.
3. Select a preset time from 0~180 min.
 - ↳ The preset time is available in multiple of 10 minutes. If you set it to "0 min", the sleep timer will be disabled.
4. You can also press the Sleep key on the remote control to set the sleep time. Press the OK key to start the sleep timer.
 - ↳ The TV will enter standby mode when the preset time is out.

Use the Sleep Timer

You can switch the TV to the standby mode after a preset amount of time.

Auto Switch to Standby Mode (Sleep Timer)

You can use the sleep timer to switch the TV to the standby mode when the preset time is out.



Tips:

- You can turn off the TV before

Use the Lock Function

This function can prevent your child watching certain programs or channels.

Set or Change the Password

1. Press the Menu key.
2. Select [Setup] → [Child Lock].
3. Press the numeric keys on the remote control to input your password.

↳ Follow the instructions on the screen to set or change your password.



Tips:

- If you've forgotten your password, please input "3448" to overwrite it.
- After setting a new password, you may need it when making some settings.

Lock/Unlock Channels

1. Press the Menu key.
2. Select [Setup] → [Child Lock] → [Lock Channel] and then input your password.
 - ↳ The channel list will be displayed.
3. Select the channel to be locked or unlocked and then press the OK key.
 - ↳ You are required to input the password when you watch the locked channel for the first time.
4. Exit the main menu, and the lock settings will come into effect immediately.



Note:

- The child lock function works in TV mode only.

Play USB Media

Video formats supported by USB:

- Storage device: USB storage (support FAT or FAT32 USB storage devices only).
- Multimedia files:
 - Photo file;
 - Audio file;
 - Video file.



Note:

- Philips gives no guarantee to the compatibility with USB storage devices, and shall not be liable for any data corruption or loss caused by connecting such device to the TV.

View Photos or Play Music and Video Files from USB Storage Device

1. Turn on the TV.
2. Insert the USB storage device to the USB port on the side of the TV.
3. Press the Menu key.
4. Select [Browse USB] and then press the OK key.

Select the USB device you've inserted and then press the OK key.

 - ↳ Enter the USB browser.

View Photos

1. Select [Photo] on the USB browser and then press the OK key.
2. Select a photo or folder and then press the OK key. The photo will be auto played in full screen.

View Photos as Slide Show

1. When a photo is played in full screen, you can press the OK key:
 - ↳ To view photos as slide show starting from the current photo.
2. Use the follow keys to control the slide show:
 - OK : play/pause.
 - ◀▶ / ▶▶ : view the previous or next photo.
 - / ↶ : exit the slide show.

Change the Slide Show Settings

1. Press the [E] key during the slide show.
2. Select one of the following options and then press the OK key:
 - [Start/Stop] : start or stop the slide show.

- [Transition Effect] : set the photo switch effects.
- [Frequency] : set the display time of each photo.
- [Random Play] : select to play the photos in sequence or at random.
- [Play Once/Repeat] : select to play the photos once or repeat playing them.
- [Rotate] : rotate the photo.
- [Capture] : set the photo as the TV's startup image or reset the startup image.
- [Details] : display the detailed information.

Listen to Music

1. Select [Music] on the USB browser and then press the OK key.
2. Select a song or album and then press the OK key to play it.

Change the Music Settings

- Press the [E] key during the music playing, select one of the following options and then press the OK key.
- [Start/Stop] : start or stop playing.
 - [Play Once/Repeat] : select to play the songs once or repeat playing them.

- [Random Play]: select to play the songs in sequence or at random.
- [Details]: display the detailed information.

Play Music for Slide Show

You can play background music for slide show.

1. Select a music album.
2. Press the OK key.
3. Press the ↩ key to return to the USB browser.
4. Select a photo album.
5. Press the OK key to start the slide show.

Watch Videos

1. Select [Video] on the USB browser and then press the OK key.
2. Select a video and then press the OK key to play it.
3. Use the following keys to control the video playing:
OK: play/pause.

◀/▶ : search forward or backward.

Change the Video Settings

Press the  key during the video playing, select one of the following options and then press the OK key.

- [Start/Stop]: start or stop playing.

- [Play Once/Repeat]: select to play the videos once or repeat playing them.
- [Random Play]: select to play the videos in sequence or at random.
- [Aspect Ratio]: select the image format for video playing.
- [Details]: display the detailed information.

Remove the USB Storage Device



Note:

- Please follow the steps below to remove the USB storage device, or it could be damaged.

1. Press the ↩ key to exit the USB browser.
2. Remove the USB storage device about 5s later.

6. Set up the Channels

When you make TV settings for the first time, you need to select a menu language and search for TV channels. This Chapter will explain how to search and fine tune the channels.

Auto Scan

Step 1: Select a menu language

1. Press the Menu key.
2. Select [Setup] → [Options] → [Menu Language] and then press ► to enter.
3. Select your desired language.

Step 2: Channel auto scan

1. Press the Menu key.
2. Select [Setup] → [Channel] → [Auto Scan] and then press ► to enter.
3. Press the OK key to start the auto scan.

Manual Scan

Step 1: Select your TV system.



Note:

- If your system has been set correctly, you can skip this step.

1. Press the Menu key.
2. Select [Setup] → [Channel].
3. Select your [Color System] and [Sound System].

Step 2: Search and save new channels.

1. Press the Menu key.
2. Select [Setup] → [Channel] → [Manual Scan].

- Select [Channel] and then press ▲▼ to select a channel number.
- Select [Search] and then press ▲▼ to start channel scanning.
- 3. When searching is finished:
- Select [Done] to save the searched channel as the current channel.

Step 3: Fine tune the analog channels.

1. Press the Menu key.
2. Select [Setup] → [Channel] → [Fine Tune].
3. Press ▲▼ to adjust the channel frequency.
4. Select [Done] to exit the fine tuning.

Channel Edit

1. Press the Menu key.
2. Select [Setup] → [Channel] → [Edit Channel].
3. Press ▲▼ to select a channel and press ◀▶ to select [Watch], [Delete] or [Skip].

7. Connect Devices

You can connect devices with different interfaces to this TV.



Note

You can connect the device to TV via interfaces of different type.

Interfaces on the back

① Audio & Video Input of PC

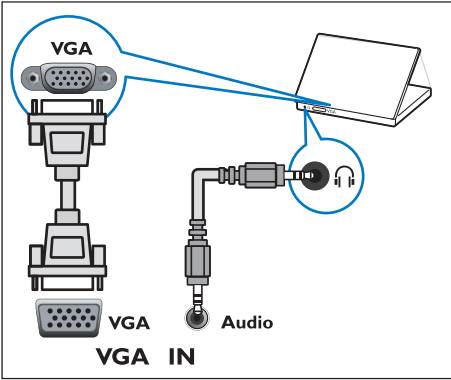

② Component Input/AV2 Input

(Video 2/Y Pb Pr Audio L/Audio R)

You can connect to analog audio & video input from analog/digital devices like DVD players or game station.

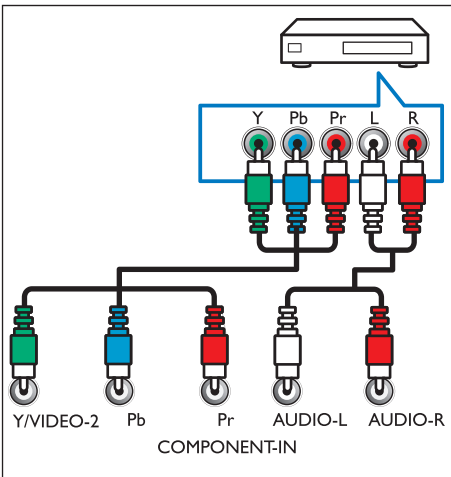

Note

Video 2 shares the same input interface with the component Y signal, and the audio of the video 2 shares the same input interface with the component audio.

③ AV Input

Composite video input of analog devices like a VCR.

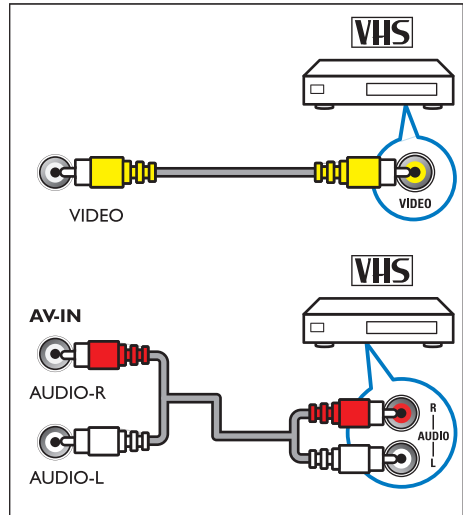

Interface on the side

① USB

Connect to USB storage device.

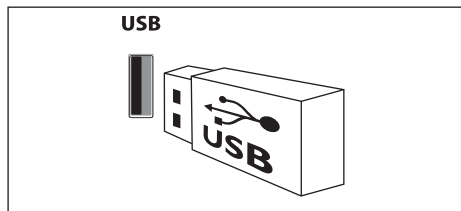

② SPDIF Audio Optical Output

Digital audio output to a home theatre or other digital audio system.

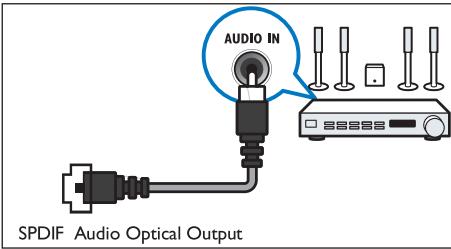

③ Headset

Stereo audio output to headset



Note

When you insert the headset, the TV speakers will be muted automatically.

④ Antenna/cable TV

Signal input from antenna, cable or satellite.

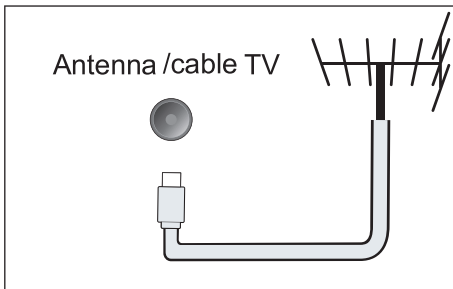

⑤ HDMI

Digital audio and video input of HD digital devices like a Blu-ray player

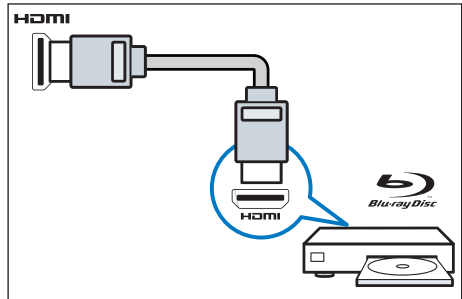

Connect to PC

Connect the TV to a PC.

- Set the refresh rate to 60Hz on the PC.
 - Select a supported resolution.
- Connect to the PC via one of the following interfaces :



Note

- An extra audio cable is needed when connecting via DVI or VGA.

- HDMI Cable

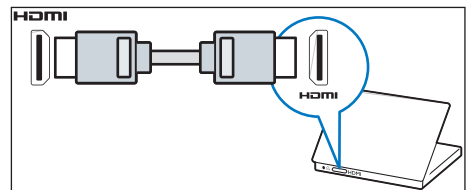

- DVI-HDMI Cable

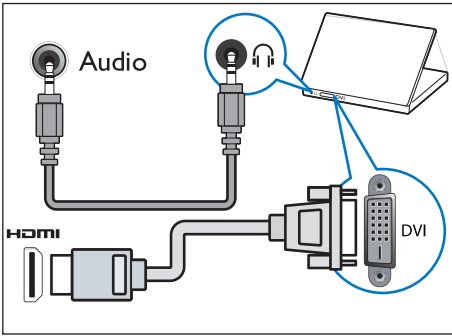

- HDMI Cable and HDMI-DVI Adaptor

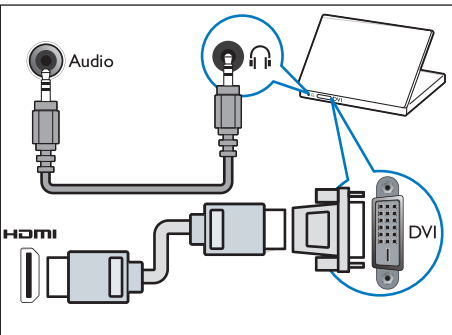

- VGA Cable

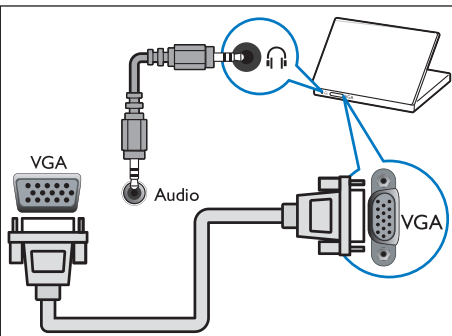

Use of Philips EasyLink

To obtain the best performance, it is suggested to use the Philips EasyLink HDMI - CEC compatible devices, which can enhance the control functions. The HDMI-CEC compatible device connected via HDMI interface can be controlled by the TV remote control. To enable Philips EasyLink, you need to:

- Connect two or more HDMI-CEC compatible devices via HDMI interfaces
- Make sure that each HDMI-CEC compatible device is working normally.
- Switch to EasyLink

 Note

- The EasyLink compatible device must be enabled and selected as signal source.
- Philips gives no guarantee that the interoperability can be realized with all HDMI-CEC devices.

Enable or Disable EasyLink

When the HDMI-CEC compatible device is enabled, the TV will be started automatically and switch to the correct signal source.



Note

- If you don't want to use Philips EasyLink, please disable it.

1. Press the Menu key.
2. Select [Setting] > [EasyLink] > [EasyLink]
3. Select [ON] or [OFF], and press they OK key.

Use of Fast Play

When EasyLink is enabled, press Play on the device.

↳ The TV will switch to the correct signal source automatically.

Use of Fast Standby

Press  (Power / Standby) on the remote control.

↳ The TV and HDMI devices connected will be switched to standby mode.

8. Product Information

The product information is subject to change without prior notice. For detailed product information, please refer to www.philips.com/support.

Display Resolution Supported

PC Format

- Resolution - Refresh Rate:
- 720 × 400 70Hz
- 640 × 480 60Hz
- 800 × 600 60Hz
- 1024 × 768 60Hz
- 1360 × 768 60Hz

Video Format

- Resolution - Refresh Rate:
- 480i - 60Hz
- 480p - 60Hz
- 576i - 50Hz
- 576p - 50Hz
- 720p - 50Hz, 60Hz
- 1080i - 50Hz, 60Hz
- 1080p - 50Hz, 60Hz

Multimedia

- Storage Devices Supported: USB storage (only support FAT or FAT 32 USB storage devices.)
- Multimedia Files Supported:
 - Image :JPEG
 - Audio :MP3
 - Video :MPEG 2/MPEG 4,H.264

Tuner/Receiver/Transmitter

- Antenna Input: 75ohm coaxial (IEC75)
- TV System: PAL,NTSC
- Video Play: PAL,NTSC,SECAM

Remote Control

- Battery: 2×AAA

Power Supply

- Main Power Supply: 100-240V~, 50/60Hz
- Standby Energy: Consumption : ≤0.5W
- Environment Temperature: 5- 40°C
- Power Consumption : 55W

TV Mounting Bracket

Please purchase the Phillips TV mounting bracket or equivalents compatible with VESA standard to install your TV.

Keep a minimum clearance behind the TV of 2.2 inch(5.5cm)to prevent damage to the cables and sockets.



Warning

Please install the TV mounting bracket according to the user instructions supplied with it. Koninklijke Philips Electronics N.V shall not be liable for any accident, personal injury or loss caused by improper installation.

Screen Size (Inch)	Dot pitch (mm)	Mounting Screw
32	100×100	4×M4

Specification

The design and specification is subject to change without prior notice as the product will be updated constantly.

- Excluding TV base
 - Size (W × H × D) : 739 × 452 × 68 (mm)
 - Weight: 6.6kg
- Including TV base
 - Size (W × H × D) : 739 × 492 × 220 (mm)
 - Weight: 7.0kg

9. Trouble Shooting

In case of trouble, before you ask for services, please conduct simple troubleshooting as below.

Common Troubles

Power -on failure:

- Unplug the power cord from the socket . Reconnect it after one minute.
- Check if the mains lead is connected firmly.

Abnormal operation of remote control:

- Check if the battery electrodes (+/-)in the remote control are proper .
- If the battery gets exhausted or leaks, replace it.
- Clean the remote control and the TV sensor.

Standby indicator light flashes:

- Unplug the power cord from the socket , and reconnect it when the TV cools down.
If this trouble still exists, please contact with the Philips customer service.

Forget the unlock password:

- Select [Child Lock]> [Change Password], and input 3448 to overwrite the current password.

Menu displayed in foreign language :

- Set the menu to your desired language.

When the TV is starting or switched to standby mode, it makes squeak sound :

- No operation is needed. This is normal when the TV cools down or gets preheating.

Channel Troubles

Image Troubles

No image after powering on the TV:

- Check if the antenna has been connected properly.
- Check if a proper device is selected as the signal source.

Sound without Image:

- Check if the image setting is correct.

Poor signal receiving may be caused by improper antenna connection.

- Check if the antenna has been connected with the TV properly.
- The receiving quality may be affected by loudspeakers, audio device without grounding, neon light, high-rise buildings, and other massive

objects. If possible, please try to change the antenna direction or keep the said devices away from the TV to improve the receiving quality.

- In case of poor receiving quality in only one channel, please make a fine tuning for this channel.

Poor image quality for devices connected :

- Check if the device is properly connected.
- Check if the image setting is correct.

Image setting not saved :

- Check if the TV setting has been set to Home Mode . You can change and save settings flexibly in this mode.

Image Size does not fit the Screen :

- Try to use another aspect ratio for image.

Improper image position :

- The image signal from certain devices may not fit the screen. Please check the signal output of the device.

Audio Troubles

Image without sound :



Notice

- If no audio signal can be detected, the TV will disable the audio output automatically, which doesn't mean trouble.

- Check if all cables are connected properly.
- Check if the volume is set to 0.
- Check if the sound is muted.

Image with poor sound quality :

- Check if the sound setting is correct.

Only one speaker works :

- Check if the Sound Balance is set to Middle.

HDMI Connection

Trouble in HDMI Devices :

- Please notice that HDCP support may cause delay to display the content of HDMI devices.
- If the TV doesn't identify the HDMI device and display no image, please try to switch the signal source to another device, and then switch back.
- In case of intermittent sound, please check if the output setting of the HDMI device is correct.

- If you use a HDMI – DVI adaptor or a HDMI – DVI cable, please check if the additional audio cable has been connected to AUDIO port (only for the mini – jack).



Notice

- Before you contact the Philips service center, please take notes of your TV model and serial number printed on the back housing of the TV and on the package.

Computer Connection

Unstable Display on TV

- Check the resolution and refresh rate is supported by your PC.
- Set the TV image format to Uncompressed.

Contact Us

If you cannot solve the troubles, please refer to www.philips.com/support for the FAQs. If it doesn't help either, please contact with your local Philips customer service center.



Warning

- DO NOT try to maintain the TV by yourself. It may result in serious personal injury, irretrievable damage to the TV, and void the warranty.

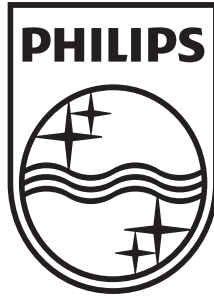

All registered and unregistered trademarks are the property of their respective owners. Specifications are subject to change without notice.

Philips and the Philips' shield emblem are registered trademarks of Koninklijke Philips Electronics N.V. and are used under license from Koninklijke Philips Electronics N.V.

2013© TP Vision Netherlands B.V. All rights reserved.