

SAMSUNG

**SAMSUNG DOUBLE-DOOR DRAWER REFRIGERATOR
INSTRUCTION MANUAL**

MODEL:

RL24MBSW

RL24MBSI

RL26MBSW

RL26MBSI

ENGLISH

SAMSUNG



- Please read through this manual before connecting to power and keep it for future reference.
- Any change relating to this manual will result in no additional notice due to continuous improvement made on our products.

DA68-01270A

Content

PART DESCRIPTIONS	1
SAFETY PRECAUTIONS.....	2
INTRODUCTION TO CONTROL PANEL.....	2
SETTINGS.....	3
PREPARATIONS BEFORE USE.....	4
DISASSEMBLING ACCESSORIES.....	5
WARNING IN USE.....	6
STORING FOODS.....	7
HOW TO USE.....	8
MAINTENANCE & CLEANING.....	9
TROUBLE SHOOTING.....	10

✪ *Please read this manual carefully for right use.*

✪ *Please read all the safety precautions included in this manual prior to use.*

✪ *Please retain this manual properly for future reference.*

TECHNICAL PARAMETERS

DESCRIPTION	MODEL	RL24MBSW/RL24MBSI	RL26MBSW/RL26MBSI
Climate type		ST	
Electric shock proof		I	
Effective volume (L)	Total volume	211	232
	Refrigerator	156	177
	Freezer	55	55
Rated voltage & frequency		AC 220V/50Hz	
Total input power (W)		135	140
Frost thaw power (W)		130	130
Power consumption kWh/24h(25℃)		0.98	0.99
Freezing capacity kg/24h		2.5	
Refrigerating agent and dosage(g)		R-134a,130g	R-134a,120g
Weight (kg)		65	68
Visual dimension(width*depth*height)(mm)		550X664X1580	550X664X1689

CIRCUIT DIAGRAM

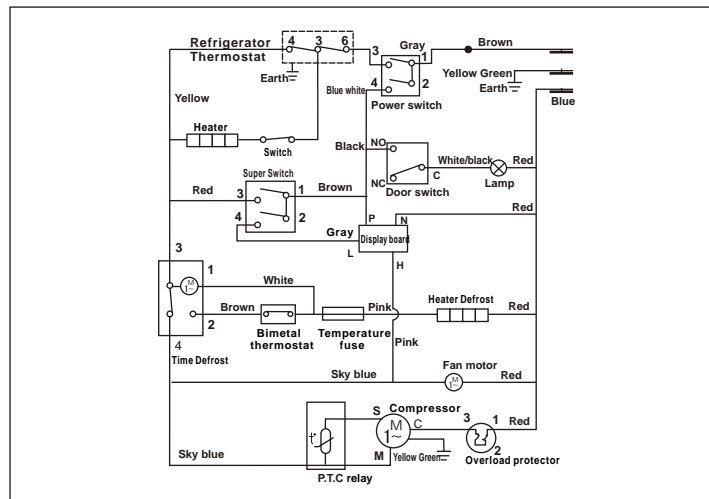

FEATURES

- Digital mode: External control and indicating the work status and inner temperature.
- Anti-bacteria&Deodorization: Clean up the odor inside and refrain germ growing.
- Fluorine-free environmental Protection: RL24EB/RL24MB/RL26EB/RL26MB is green products protecting the environment.
- Frost-free & freshness retention: The freeze adopts air cooling with efficient heat conduction and fast freezing, which can protect the food cell and freshness. The direct cooling formula applied to the refrigerator makes for good water retention of foodstuff.
- Reliable performance: The sealed and high-powered name-brand compressor gives out excellent performance and high reliability.
- Reasonable layout: The storage-up and freezing-down structure can retain the cool air by less power consumption. The frequently used refrigerator is set in the top for convenient handling. The refrigerator shelf may vary with the container size.
- Odor retention: The freezing compartment was drawer-structured to retain pure smell by preventing odor from escaping.
- Flat back: The built-in condenser gives easy access to cleaning.

ACCESSORIES

Model	Name	Tray fre	Shelf ref	Fruit&vegetable groupware	Tray cover	Egg guard	Egg tray	Bottle guard	Ice tray	Cheese tray	Winebottle rack
RL24MBSW RL24MBSI		3	2	1	1	2	1	1	1	-	-
RL26MBSW RL26MBSI		3	3	1	1	2	1	1	1	1	1

DESCRIPTIONS OF LOCATIONS(demonstration based on RL26MBSW)

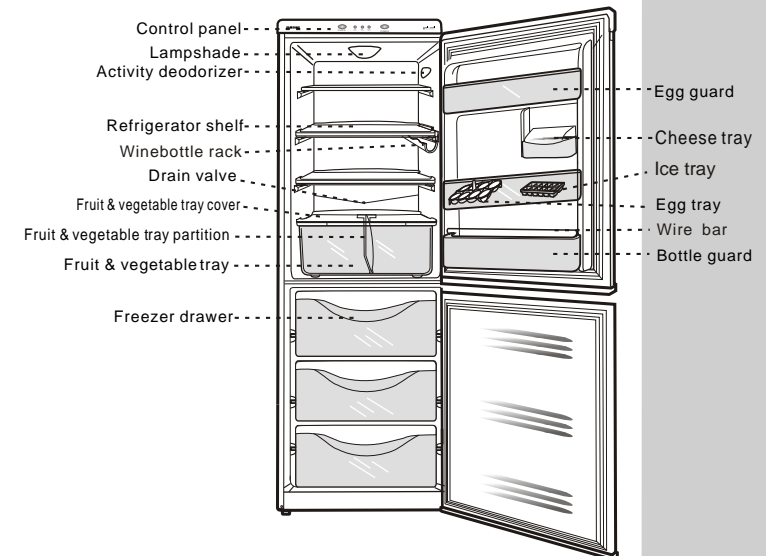

SAFETY PRECAUTIONS

Children Warning

The glass shelf is movable, please alert the children do not move it as it is heavy and easily causes hurt.

Read Instructions

Before initiating the power, make sure to read all the safety and operating instructions in this manual.

Keep Instructions

Please keep this manual properly for future reference.

Heed Warning

Please follow all instructions on the refrigerator and this manual.

Follow the instructions of this manual in practice.

All procedures and instructions should be adhered to during operation.

Please refer to the Model and Serial Number for your unit.

This manual includes four similar models of RL24MBSW, RL24MBSI, RL26MBSW, RL26MBSI, where RL26MBSW is dominant by discriptions.

Date purchased: _____
Model No.: _____
Serial: _____

INSTRUCTIONS ON MECHANICAL REFRIGERATOR DISPLAY PANEL

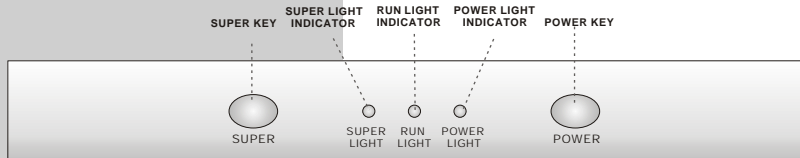

Display unit

1. When power is on, press the power key to activate the power light to initiate the appliance.
2. If super is necessary, then press the super key to activate the super light. If this function is not required, repress the super key to turn off the super light. Otherwise, the appliance will keep working.
3. When super is cancelled, repeat action is not recommended within 5 minutes.
4. Power key, super key shall not be pressed frequently in succession. The interval between each action shall be above 5 minutes to protect the compressor.
5. The appliance is not suitable for long super action (super light on). It must be recovered from the super state within 3 hours as the refrigerator temperature will drop under 0°C due to long super action.

Bicker is heard.

- It's the sound arising from refrigeration agent when it flows.
- It is not malfunction.

Dew is found in the fruit and vegetable room.

- It occurs when the door is open for a long time.
- The fluid food is not sealed.

The water result from frost thaws floods in the refrigerator.

- The drainage outlet is blocked.
- Dredge up the drain-hose with drainage plug or similar aids.

When the freezing function is not adequate.

- The door is not shut properly.
- The temperature setting is too hot.
- The door gasket is damaged or deformed, which impairs the sealing effect.
- The refrigerator is laid near heat resource and exposed in the sunlight.
- The refrigerator is stuffy inside.

Long time running takes place

- Hot in summer.
- The door is opened and closed frequently.
- The temperature setting is too low.
- The ventilation outside of the unit is in bad situation.

Dew appears on the inner bottom and frame.

- The environment is too moist.
- Not a trouble, just wipe it by cloth.

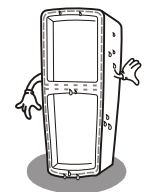
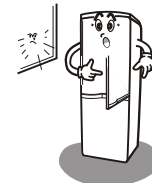
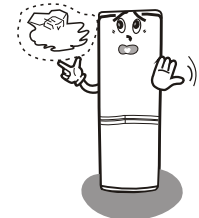
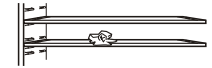
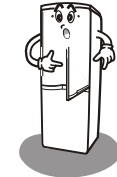
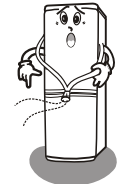

TROUBLE SHOOTING

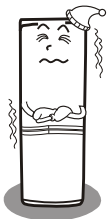
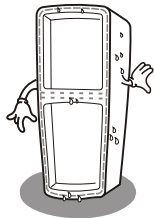
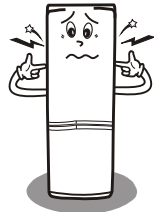
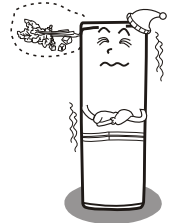
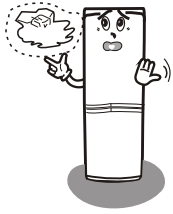

Refrigerator stops working

- The plug is connected improperly .

The foodstuff in the refrigerator was frozen up.

- The temperature setting is too low.
- The foodstuff is in contact with the back cold resource.
- The appliance is under the state of deepfreeze.

Refrigerator omits noise

- The inner items are not evenly placed.
- The refrigerator is installed unevenly.
- The unit is located too close to wall.
- The external refrigerating pipe is in collision with each other or the unit wall.
- There are foreign objects behind or under the unit.
- The noise is generated during compressor operation.

The front or side wall grows hot

- For the sake of restraining water steam condensing on the unit frame, the frame is embedded with dew proof pipe that will heat during the unit operation. It is not a problem.
- In both sides of the refrigerator was fitted with devices to drive off heat (condenser).

There are frost arises on the refrigerator wall.

- It's a normal condition when the machine works.
- The frost will vanish automatically when the machine stops running.

SETTINGS

- The refrigerator should be placed on the flat and firm floor. In case of any unevenness, regulate the adjustable foot under the body to level the refrigerator (counterclockwise means rising).

- Leave at least 55mm between the unit back and the wall and allow 300mm or more above.

- The refrigerator shall be away from hot resource and direct sunlight.

- Don't place the refrigerator in moisture as the metal parts will get rust and impair the insulation effects. In the event of natural disasters (such as rainstorm, accidents), the submerged unit shall not be put into use until nominated SAMSUNG service center repairs it and proves that it is in good condition.

- Ground properly for personal safety. The refrigerator shall not be grounded via phone wire or gas pipe.

- Don't press the power cord.

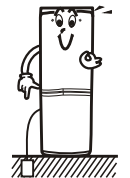
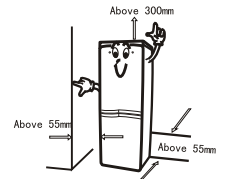
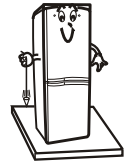

PRIOR TO USE

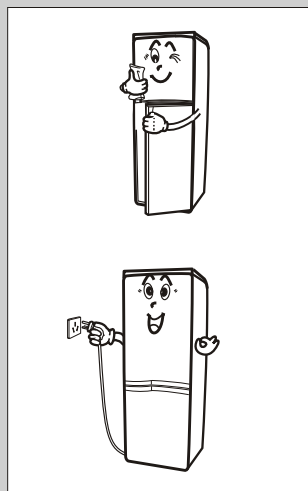

- ✦ Remove the four sponge tapes from the two ends of glass shelf and adjust the shelf at the proper position.
- ✦ Clean the inner and outer of the appliance using warm and wet cloth (some detergent is allowed in the warm water)
- ✦ The refrigerator is set under the initial status, refer to temperature control (P-9) for adjustment operation.

Caution:

- ✦ After using the freezer, don't forget to shut the drawer before closing the door.
- ✦ Before electrifying the appliance, please check whether the rated voltage is in parallel with the power source. The rated voltage is permitted within 187-242V. If your power voltage is in discrepancy, an automatic voltage transformer above 500W shall be necessary. You can get the suitable products from the market.

ASSEMBLING OF BOTTLE RACK

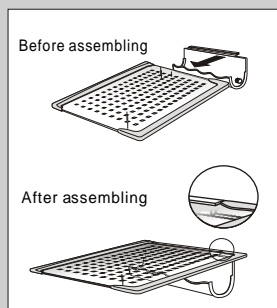

- ✦ Fix the bottle rack onto the glass shelf as described in the left demonstration.

MAINTENANCE & CLEANING

- ✦ **Interior parts**
Dismantle all shelves, bars, trays, covers and drawers, and clean with a warm damp cloth wiper.
- ✦ **Door gasket**
Clean door gasket with care. Wipe the recessed place with chopstick wrapped with cotton strip.
- ✦ **Water tray**
Screw off the screw in the compressor cover, pull up the water tray lightly and draw it out. Fix it as before after washing.
- ✦ **Defrost approach**
Thick frost layer depositing on the interior wall will affect refrigeration effects. On that account, you may cut off the power after taking out the foods and placing somewhere in good package. Wipe off the water soil with a soft cloth when the frost layer thaws. Afterwards, switch on the power and restart the machine to reset the temperature.

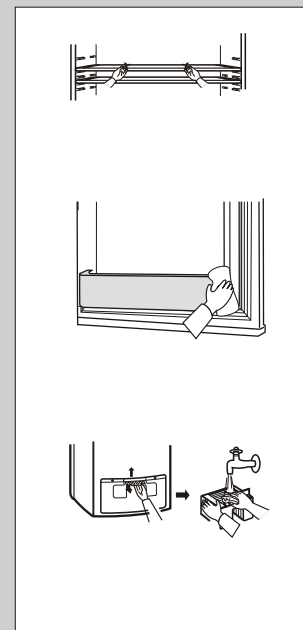

Cautions:

- Never place the refrigerator upside down and horizontally. If tilting is required, the angle between compartment body and the ground shall be at least 45°.
- In the initial use, remove the four sponge tapes from the glass shelf and fit the shelf. Embed the protuberance at both sides to the grooves to fix them properly.
- Never move the refrigerator by door handle or impose large force on the handle up and down.
- The intervals between plug pulling and plugging shall be more than 5 minutes.

MECHANICAL TEMPERATURE ADJUSTMENT

RL24MB

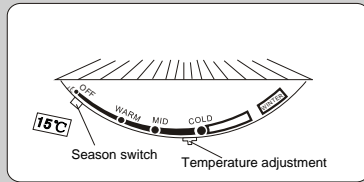

- The temperature is adjusted by the slide under the control of temperature controller. The signs, strong, mediate and weak, on the knob receptively indicate the inside temperature condition. Under the same circumstance, stronger the knob reflects, lower the inside temperature is. "Close" means stopping working.

RL26MB

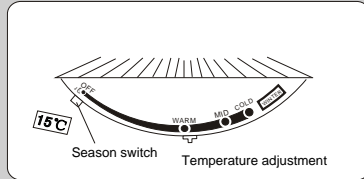

- In normal use, adjust the slide at the mediate and change it to the location between weak and mediate if any hot weather. If the room temperature is below 15 °C, then open the season switch and change the slide to the location between mediate and strong. If the room temperature is below 10 °C, it's a must to locate the slide at the Winter area.

FRUIT AND VEGETABLE COMPARTMENT

- You may adjust the moisture of the fruit and vegetable compartment by the moisture control slide. The slide towards the two sides may increase the moisture, vice versa.
- The partition of the fruit and vegetable tray separates the fruit and vegetable compartment into two parts. You are allowed to adjust it according to the fruit and vegetable types and quantities to meet a satisfactory need of storage space.

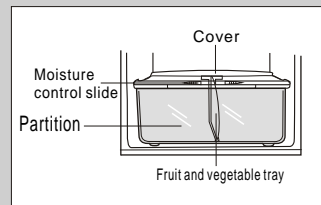

- The fruit and vegetable compartment is able to preserve the water content and freshness of the fruits and vegetables as it is sealed to prevent cold air touching the fruits and vegetables.
- It is appropriate to the storage of vegetables and fruits.

Caution:

Tropical fruits, such as banana and pineapple are not recommended.

DISASSEMBLING PARTS

- Refrigerator shelf**
Lift the shelf head and pull it out. (Position the shelf as per the container height)
- Fruit and vegetable tray and cover**
Draw out the fruit and vegetable tray. Lift up the cover head to pull it out.
- Freezer tray**
Draw out it till the block, lift the shelf rear and pull it out.
- Egg guard and bottle guard**
Lift them up to take them down.

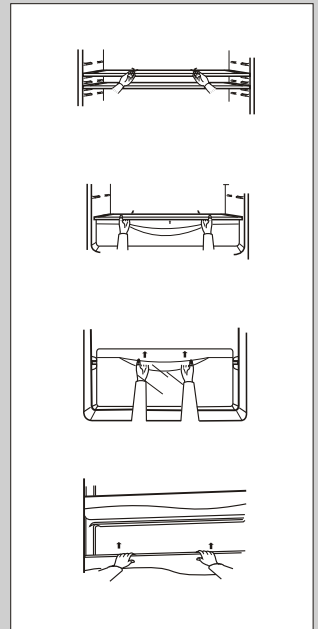

CHANGE THE INTERIOR LAMP

- Pull out the plug**
Turn off the screw in the lampshade inner wall, hold the lampshade with palm and push forward to take out the lampshade.
- Turn off the lamp counterclockwise.**
- Screw on the lamp clockwise.**
Hang on the hook under the cover and turn upward to push into the upper hook. Afterwards, refit the screw into the lampshade interior wall.

Lamp parameter: 220V/240V, 15W

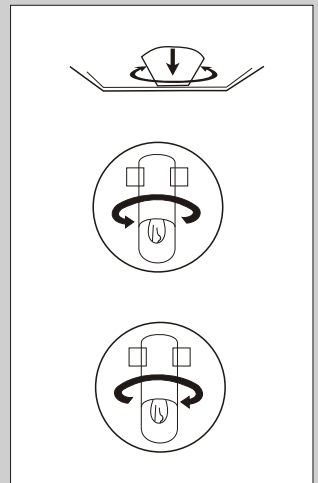

WARNING IN USE

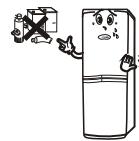
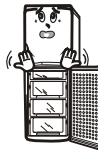
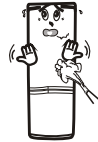
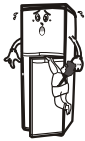
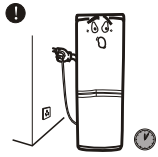

- ⚠ **Cautions:** damaged power cords should be replaced by the manufacturer nominated service outlets, as special tools are required.

The power cut-off should not be reconnected within 5 minutes to prevent the compressor being damaged.

- ⚠ Never use the combustible sprays like lacquer and paint near the machine for those will cause blasting hazard.

Caution: do not use the unit outdoors or in the rain.

- ⚠ Don't let children play with or hang on the unit as this will damage the unit or hurt children.

- ⚠ Do not splash the water to the unit back as this will impair the insulation.

- ⚠ Most importantly, open the door neither for a long time nor frequently in hot quarter, as the effects of the sets will be impaired with increasing workload.

- ⚠ Neither store inflammable, explosive items, strong acid and alkali corrosive items, such as butane, ether, benzene, sulfuric acid, gas, alcohol and so on, nor put the bottled fluid food in the freezer as the bottle might crack.

- ⚠ When the refrigerator works in malfunction, or is damaged, operation shall be stopped immediately. Cut off the power and call the local service center. Damaged power cord should be replaced by the manufacturer representatives or the personnel with same qualification.

STORING FOODS

- ⚠ Pack the foods with freshness reserving bags (films) or seal the food container with a lid to prevent drying or bad odor escaping.

- ⚠ Hot food and drink should be cooled to the room temperature before putting into the refrigerator.

- ⚠ The cooked and raw foods shall be placed separately.

- ⚠ Please do not put the goods near the temperature sensor to ensure the correct indication of temperature.

- ⚠ Store foods in smaller portions.

- ⚠ Dry the fruits and vegetables for storage after washing.

- ⚠ Fruits and vegetables shall be placed in the fruit and vegetable room to retain their water content and freshness.

(Caution: Tropical fruits, such as banana and pineapple are not recommended.)

