

SENCOR®

Let's live!

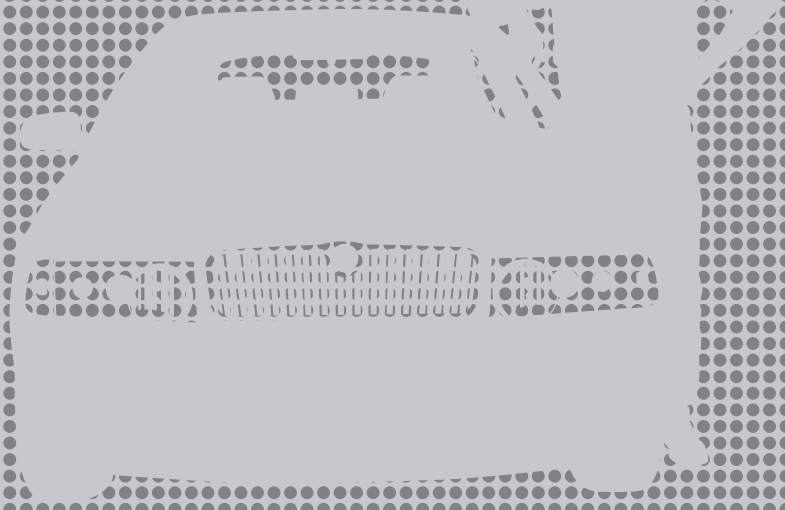

**Car Stereo MP3 player with PLL FM Stereo receiver / RDS /
USB / SD/MMC / frontal AV input
7-inch LCD display with touch screen
Removable front panel
BLUETOOTH function in telephone mode**

USER'S MANUAL

SCT 9410BMR

EN



Contents

1. Important safety instructions.....	2
2. Device	4
2.1. Main unit.....	4
2.2. Remote controller	5
3. Installation, basic controls.....	6
3.1. Preliminary measures	6
3.2. Removal and replacement of the front panel	6
3.3. Cleaning connector	7
3.4. Assembly.....	7
3.5. Maintenance	8
3.6. Using the remote control and its care.....	9
4. Operating instructions	10
4.1. Basic controls	10
4.2. Listening to radio	11
4.3. Using RDS function	12
4.4. Playing files from memory card / USB device.....	13
4.5. Front AV input.....	13
4.6. Listening to Music	13
4.7. Watching video	14
4.8. Photo preview	15
4.9. BLUETOOTH function.....	16
4.10. Telephone pairing.....	16
4.11. General settings	17
5. Technical data.....	18

1. Important safety instructions



This symbol indicates the presence of dangerous voltage within the device, where there is a risk of electric shock.

CAUTION

RISK OF ELECTRIC SHOCK – DO NOT OPEN!

WARNING: TO REDUCE THE RISK OF ELECTRIC SHOCK, DO NOT REMOVE THE COVER OF THE DEVICE, THE DEVICE DOES NOT CONTAIN PARTS THAT CAN BE REPAIRED BY THE USER. ENTRUST ANY MAINTENANCE OR REPAIRS TO PROFESSIONAL SERVICE CENTRE.



This symbol indicates important operating instructions and warnings inside the manual supplied with the device.

Note:

Specifications, features or operation of this device may change without prior notice due to continuous improvement and development of its technology.

- Read these instructions. Follow this manual and the instructions inside.
- Heed all warnings.
- Follow all instructions.
- Use only the attachments and accessories specified by the manufacturer.
- You must not put an open flame on the device, e.g. a burning candle.
- Use the device in temperate climate.
- The manufacturer and vendor of the device are in not in any way liable for any direct or indirect damages caused by not following the instructions for installation, setup, operation, maintenance and cleaning of the device mentioned in this manual.
- Protect the device against impacts, falls, blows, shocks, vibration, moisture and dust.
- Before you agree to the use of the device by children, the children must be instructed in an age-appropriate manner about safe use of the device.
- Leave free space around the device, it is necessary for proper air circulation.
- The device must not be exposed to dripping or running water and you must not place upon it objects filled with liquid, e.g. vases. Protect the device against becoming wet, sprayed on or poured on by any liquid, do not leave or install the device outdoors. You risk electric shock or fire by not adhering to these instructions.
- Do not use gasoline, thinner or other solvents or abrasives, scouring pads, or sponges with scouring pads to clean the device.

The car radio should be operated only if the traffic situation allows it.

The volume of the audio output should be set so as to always hear acoustic signals from outside, e.g. signals of vehicles with priority right of way like the police, ambulance and fire brigade.

**CAUTION**

Pay attention in the first place to driving your vehicle! As a driver you are fully responsible for traffic safety. Only use the functions of the car radio so that you have in all traffic situations control of your vehicle!

Because of the wide range of SD / MMC cards / USB devices on the market we cannot ensure the compatibility of the device with all types of SD / MMC cards / USB devices.

Notice when displaying static images, red/blue/green/black spots on the screen.

Displaying a static image can permanently damage the LCD panel.

Do not display a static image on the LCD panel for a period longer than 2 hours. Risk of the image staying on the screen. This is referred to as the image being "burned into the screen." To prevent this from occurring, reduce the brightness and contrast level of the screen when viewing static images.



The warranty does not apply to damage caused by the reasons stated above!

Red, blue, green and black pixels may appear on the screen.

This is typical for liquid crystals and is not a defect. Liquid crystal displays are produced via very precise technology with fine picture details. Inactive pixels can occasionally appear on the screen represented by solid red, green, blue or black pixels (a maximum of 0.001% of the total number of pixels). Notice that this does not affect the LCD screen performance.

Notes on the USB connector:

USB memory devices require being connected directly into the device. To prevent a failing or interrupting data transfer, do not use USB extension cable. Electrostatic discharge can cause the device to not function. In this case, the user must restart the device. Before using a USB memory device, test that it communicates with the device and its read and write speed.



Reproduced loud sound can cause hearing damage, listening to such a sound long-term can lead to hearing loss.

2. Device

2.1. Main unit

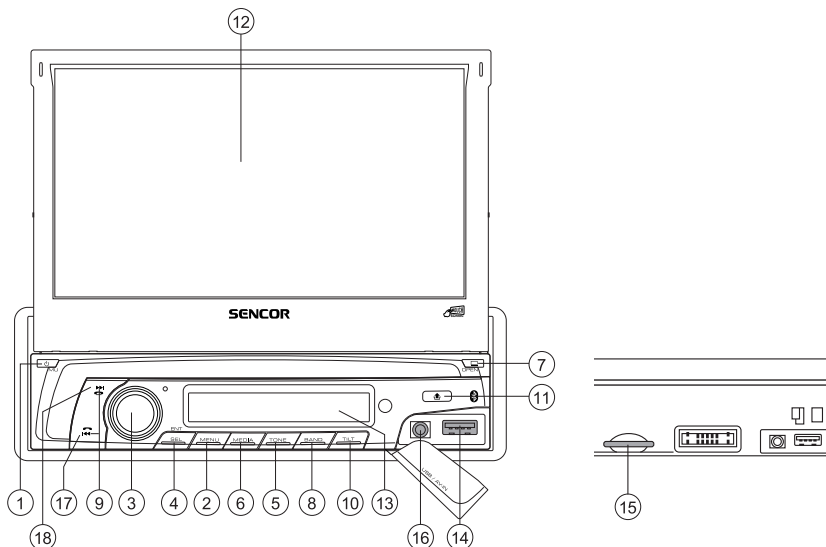

- 1) SWITCH (⏻) / SOUND OFF (🔇)
- 2) MENU (BACK FUNCTION)
- 3) VOLUME CONTROL
- 4) FUNCTION SELECTION (SEL) / ENTER (ENT)
- 5) VOLUME ADJUSTMENT
- 6) SWITCH MEDIA (USB / MEMORY CARD)
- 7) CLOSE/OPEN DISPLAY
- 8) SELECTION OF RADIO BANDWIDTH
- 9) AUTOMATIC OR MANUAL TUNING (INCREASING ►► OR DECREASING FREQUENCY ◄◄ /TRACK/ SEARCH)
- 10) ANGLE OF DISPLAY TILT
- 11) RELEASE PANEL BUTTON (🔑)
- 12) TFT-LCD DISPLAY
- 13) NUMBER PAD DISPLAY
- 14) USB PORT
- 15) MEMORY CARD SLOT
- 16) FRONT AV INPUT
- 17) RECEIVE CALL (☎)
- 18) END CALL (📞)

2.2. Remote controller

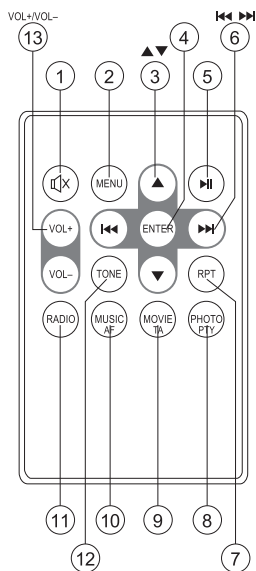

- 1) SWITCH OFF SOUND (🔇)
- 2) MENU (BACK FUNCTION)
- 3) MOVE
- 4) ENTER
- 5) PAUSE
- 6) AUTOMATIC OR MANUAL TUNING (INCREASING ►► OR DECREASING FREQUENCY ◀◀ / SEARCH)
- 7) REPEAT PLAYBACK
- 8) PICTURE PREVIEW / PROGRAM TYPE
- 9) MOVIE / TRAFFIC ANNOUNCEMENTS
- 10) MUSIC / ALTERNATIVE FREQUENCY
- 11) RADIO
- 12) VOLUME ADJUSTMENT
- 13) VOLUME CONTROL

3. Installation, basic controls

3.1. Preliminary measures

- Select the installation location carefully so that the device does not interfere with normal operation and driving functions of the vehicle.
- Do not install the device in places where it may be exposed to high temperatures, e.g. In direct sunlight or near the outlet of hot air from the heater, or in a place subject to dust, dirt or strong vibrations.
- Use only the supplied accessories for firm and safe installation.
- Before installing the device, remove the front panel.

Note:

Tilt angle for car radio installation must not exceed 30°, otherwise the front panel will not open.

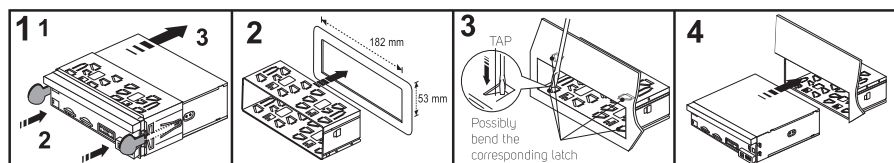

Note:

Keep the release key in a safe place because you may need to remove the device from the vehicle.



CAUTION

Do not touch the connectors on the front panel of the main unit, it may result in poor electrical contact. Maybe only wipe the connectors using clean cloth. After removing the front panel from the main unit, store it in a protective case.

3.2. Removal and replacement of the front panel

The front panel of this unit can be removed and thus deter potential thieves from stealing your device.

Before removal of the front panel first press  to switch the device off. Press  to release the front panel.

Pull the panel toward yourself and thus disconnect it from the main unit. Follow instructions.

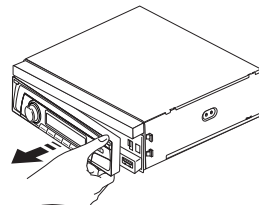

When replacing the front panel on the unit make sure that it is right side up. You cannot install it if it is upside down. Attach the B side of the panel to the A side of the main unit. Insert the panel in the unit and push until you hear a click.

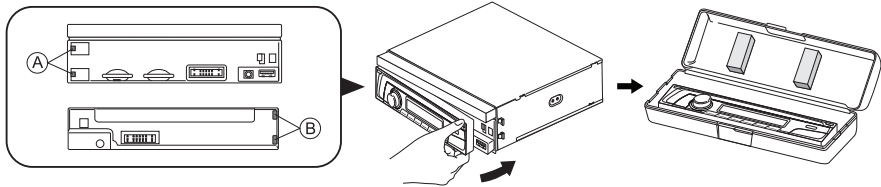

Notes:

- When reinstalling the front panel, do not use excessive force to push it to the main unit. Only gentle pressure to the main unit suffices to install it.
- When you carry the front panel with you, put it in the supplied case for the front panel.
- When installing the front panel on the unit, do not push with excessive force on the display window.

3.3. Cleaning connector

If the connectors between the unit and the front panel become dirty, the device may not function properly. To prevent it, remove the front panel by pressing  and from time to time clean the connector.

Clean the connector with a cotton swab and contact cleaner as shown. Clean the individual outputs thoroughly and be careful not to damage the contacts. Dry thoroughly before turning on.

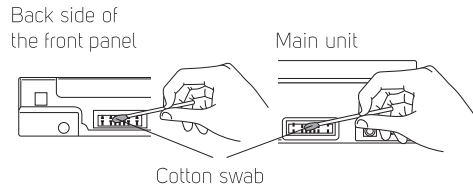

3.4. Assembly

- 1) UNIT
- 2) ASSEMBLY FRAME
- 3) DASHBOARD
- 4) HEXAGONAL NUT
- 5) LOCK WASHER
- 6) REGULAR WASHER
- 7) VEHICLE BODY
- 8) REAR SUPPORT STRAP

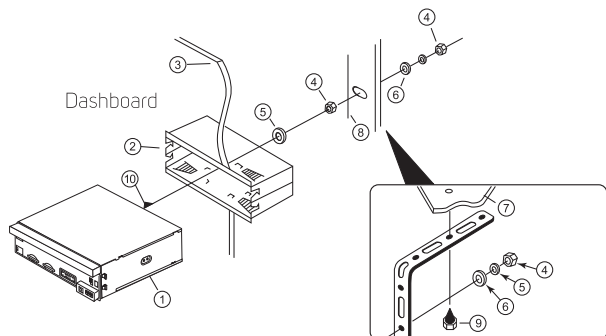

- 9) SELF DRILLING SCREW
10) HEXAGONAL SCREW M5 X 15 10

3.4.1. Wiring connection

Parking: Grey/white

Connect to the parking brake switch of the vehicle

Reverse: Red

Connect to the reverse lights switch

RCA video output connector: Yellow

Connect to the external A/V system for display

RCA camera input connector: Blue

RCA line output connector:

Red (right) White (left)

Antenna connector

External microphone for calls

Bluetooth antenna

CONNECTOR A

4. MEMORY +12V
5. VEHICLE ANTENNA OUTPUT
7. +12 V (TO STARTER)
8. GROUND

3.5. Maintenance

Changing the fuse

If the fuse burns out, check the power supply connection and replace the fuse. If the fuse burns out again after replacement, there may be an internal malfunction. In this case, contact the nearest service center.



WARNING

Use fuses with specified value for each conductor. Using a fuse with a higher value can cause severe damage.

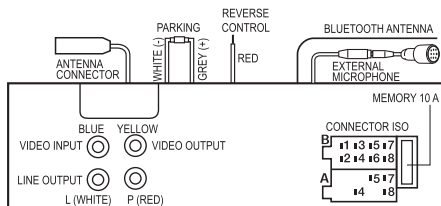

Note: (connector A no. 7) must be connected behind the ignition key to prevent the discharge of battery when the vehicle is not in use and the ignition key is turned off.

CONNECTOR B

1. RIGHT REAR SPEAKER (+)
2. RIGHT REAR SPEAKER (-)
3. RIGHT FRONT SPEAKER (+)
4. RIGHT FRONT SPEAKER (-)
5. LEFT FRONT SPEAKER (+)
6. LEFT FRONT SPEAKER (-)
7. LEFT REAR SPEAKER (+)
8. LEFT REAR SPEAKER (-)

3.6. Using the remote control and its care

Inserting a battery

Open the compartment on the back of the remote control and insert the battery with the positive (+) and negative (-) terminals pointing in the right direction.

- When using the first time, remove the foil sticking out from the compartment.

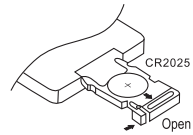

WARNING

- If you do not plan to use the remote control for a month or longer, remove the battery.
- Do not recharge, disassemble, heat or incinerate the battery.
- Do not store the battery with metal materials.
- In the event of a battery leak completely clean the remote control, and insert a new battery.
- When disposing of used batteries observe local laws and rules that apply in your country / region.
- Always make sure that when inserting the battery you keep the correct polarity.

Using the remote control

When using the remote control point it in the direction of the front panel.

IMPORTANT

- Do not leave the remote control in places exposed to high temperatures or direct sunlight.
- Prevent the remote control falling to the floor, where it could get stuck under e.g. the brake or gas pedal.

4. Operating instructions

4.1. Basic controls

Turning device on/off (⏻)

Turn the device on by pressing “⏻”. Press again and hold the button to turn the device off.

Main menu

- Press **Menu**, by first tap on the display select the operating mode and select it with second tap. Options Radio, Music, Movie, Photo, Bluetooth, AV in, Setting.
- Press **Menu** to enter the main menu. Turning the VOL control choose from items Radio, Music, Movie, Photo, Bluetooth, AV in, Setting. Press **SEL** to select mode.

Note:

Tap the icon  on the screen to exit menu.

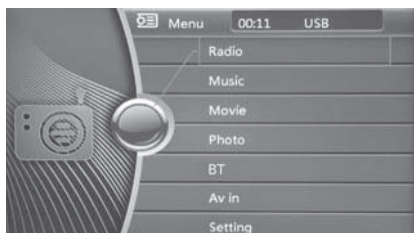

Source selection (MEDIA)

Press repeatedly **MEDIA** to switch between USB and memory card if both are inserted.

Setting volume

- Main unit: When turning **VOL** knob right or left you increase or lower volume.
- Remote control: Press **VOL+** or **VOL-** increase or lower volume.

Sound adjustment

Press shortly **TONE** to select from options VOL (Volume), BAS (Bas), TRE (Treble), BAL (Balance), FAD (Fader/Front-Back), EQ (Equalizer), LOUD (Loud). Turn the knob VOL to change the displayed menu items.

Muting sound

- Main unit: Press **MU** to switch off sound immediately. Press again to resume the previous volume.
- Remote control: Press .

Open/Close display (⏻)

Press  to close display. Press again to open display.

Angle of display tilt (TILT)

Press repeatedly **TILT** to select the required angle of the tilt.

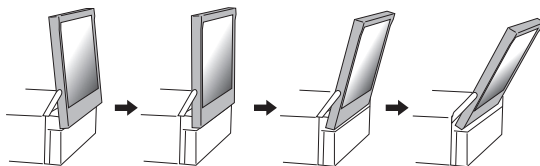

4.2. Listening to radio

Press **Menu** and double tap on the display to select the radio option.

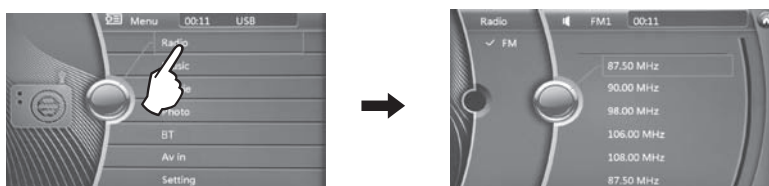

Use manual or automatic tuning to find a station you want to listen to. You can also save the current station and when you listen to the radio you can quickly select preset stations.

Note:

Switched on modes AF, TA, PTY affect the search and storing of stations by their signal strength and content of services. Keep it in mind when tuning or turn them off.

Bandwidth

Press repeatedly **BAND** to search among the bandwidths. FM1---FM2---FM3.
Remote control: Pressing the button **RADIO** has the same effect.

Automatic or manual tuning

By pressing shortly **◀◀** or **▶▶** you can perform manual tuning.
Press and hold **◀◀** or **▶▶** to search automatically for stations in the upper or lower bandwidth.

Automatic storage

Tap the button **AMS** on the display. Search will immediately start. The indicator of station and memory position appears. Automatic storage will occupy as many as possible memory positions of stations with acceptable reception according to entered RDS modes.

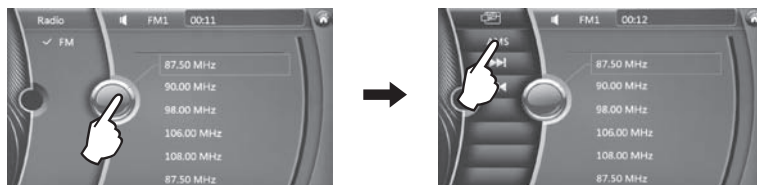

Bandwidth storage

The current screen displays only six preset stations. You can easily store up to six broadcast frequencies for later recall with the touch of a button.

1. Select the desired bandwidth and click on the desired memory position.
2. Tap the buttons to Seek Up (Seek up) or Seek Down (Seek down) to select the desired station. Newly tuned station is automatically saved under the corresponding memory location.

Frequency recall

- Tap on the required memory position on the display or press and hold **SEL** and immediately turn the volume knob, press **SEL** to recall the radio station from memory.

Note:

You can store up to 6 station for each frequency.

4.3. Using RDS function

What is RDS?

RDS (Radio Data System) is a digital information system developed by the EBU (European Broadcast Union). System RDS, embedded in the normal FM broadcasts offers a variety of information services and auto-tune function in car radios compatible with this system. In 1988, RDS has been put into operation in Great Britain, France, West Germany, Ireland and Sweden. Check whether and how is RDS used by stations in your area.

Function "AF" (Alternative Frequencies)

- Press the left side of the touch screen and the menu ANS appears. Tap the item [AF] to select automatic frequency mode.
- The radio constantly checks the AF signal strength, and if it is too weak, the device detects from the AF signal on which frequencies should it search for a better transmitter.

Function "TA" (Traffic Announcement)

Press the left side of the touch screen and the menu ANS appears. Tap to turn the mode on or off [TA]. When TA mode is turned on it receives traffic information if it is broadcasted.

- If the volume level is below the threshold level it will increase to the threshold value.

Function 'PTY' (Program Type)

1. Press the left side of the touch screen and the menu ANS appears. Tap on the item [PTY] to turn on the function Program type.
2. Turning the VOL knob select the program type.
3. When the desired program appears, simply press PTY again and the device will scan for available stations.

Note:

Program type flashes during the search.

4.4. Playing files from memory card / USB device

The device is equipped with USB interface and memory card reader.

1. Connect a USB memory device to the USB port.

Note: To protect the USB port from dust, the cover of the USB port is automatically closed by a spring. Start the USB device before connecting it.

2. If you are using a memory card, insert it into a card reader under the removed front panel.

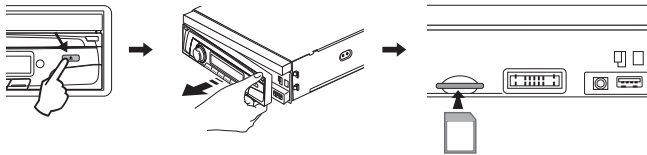

4.5. Front AV input

External audio / video source can be connected to the AV IN jack and played through the vehicle's speakers.

- Connect AV IN to the Audio/video output on the external device.

4.6. Listening to Music

Press **Menu** and double tap on the screen to select the item Music. Using MEDIA button you can select the source USB / memory card. Press and hold **SEL** and immediately turn the volume knob to select the required song. Press **SEL**.

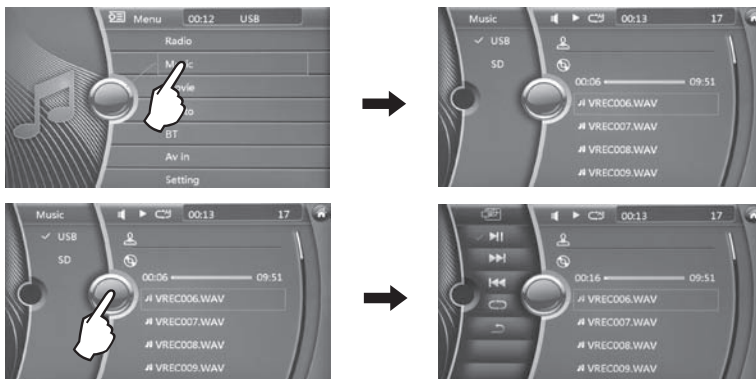

Fast forward/reverse

1. During playback press and hold **⏮** or **⏭** and the device quickly moves position in the song.
2. If you want to resume playback from the desired position, release the button.

Note: During the quick move the sound is not played.

Search for the beginning of the song

During playback press **⏮** or **⏭**.

⏮: Press to start playing from the beginning of the previous chapter or track.

⏭: Press to start playing from the beginning of the following chapter or track.

Pause playback

During playback press **⏸** on the remote control or press **SEL** on the main unit. Press again to resume playback.

Repeating tracks

You can choose between repeating a single track or all tracks.

1. Press **RPT** on the remote control or tap **🔄**/**🔄**/**🔄** on the touch screen during playback.

2. Each time you press this button, the device switches between the following modes:

Repeat 1 **🔄** – repeating the currently played track.

Repeat All **🔄** – repeating all tracks.

Repeat **🔄** – repeat function is turned off.

4.7. Watching video

Press **Menu** and double tap on the screen to select the item Movie. You can select source USB / Memory card. Turn the volume knob to select the desired video. Press **SEL**.

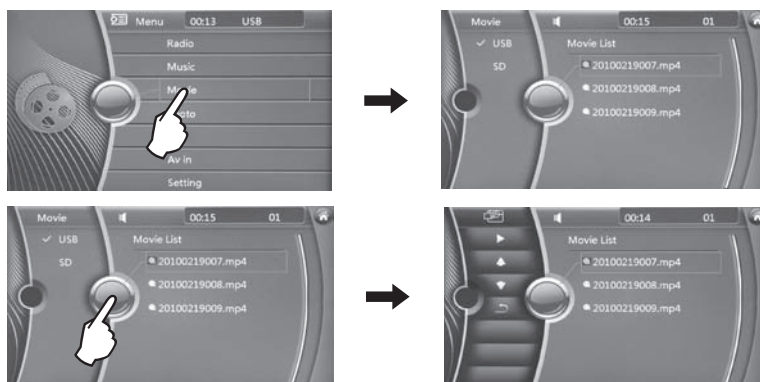

▶ : press to pause / resume the video playback.

⏮/**⏭** : searching for previous/next video.

↶ : press to return.

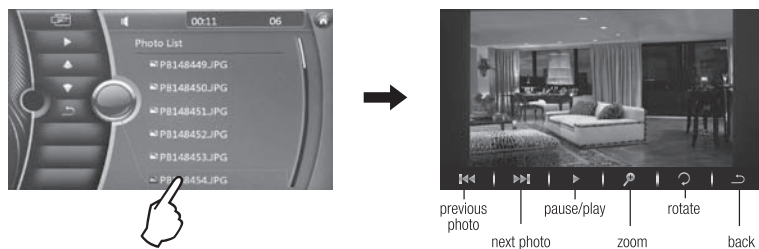

4.9. BLUETOOTH function

If you want to use the Bluetooth function, press the MENU button on the front panel. Select the "Bluetooth" symbol on the touch panel and double tap.



4.10. Telephone pairing

- Activate the Bluetooth feature on your mobile phone and make a search for Bluetooth devices. After successfully finding it the display of the mobile phone shows the item "CAR BT" of the device.
- Select this device for connection and after prompt to enter a password, enter the password of the device **1234**. It may be necessary to confirm the connecting structure again.



Dial mode

If you want to make a call, dial the contact number on your mobile phone or you can dial out from the device and make a call. To answer a call on a mobile phone or on the front panel of the device. You can speak directly via the hands-free function of the device using the speaker supplied as a separate accessory. To end a call just press the button End call on the telephone or press "☎" on the front panel.

A2DP mode

If your phone supports this mode, the main unit can play music located on your phone. Select the music in your phone you want to play (e.g. an album) and press Play / Pause button on the main unit. Music will play from the speakers connected to the main unit in the car.

Note:

For compatible players with A2DP, their control and how to handle calls while listening to music, read the manual of your phone or contact its manufacturer.

AV IN

Press **Menu** and double tap on the screen to select the item AV In.



4.11. General settings

Press **Menu** and double tap on the screen to select the item Setting. Tap the screen to choose from Interface Language (Language Pack video subtitles, SRT, the same file name), Date, Clock Mode, Time, Key tone, Repeat, Output PAL/NTSC. Turn the volume knob to change the required setting.

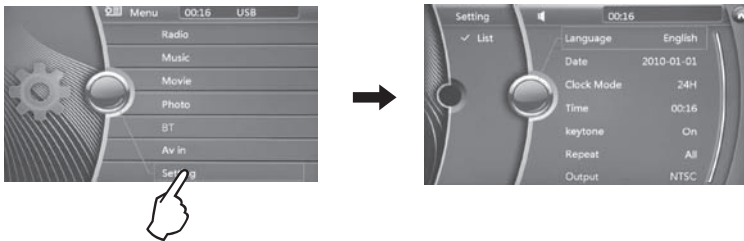

5. Technical data

MP3 player

Signal to noise ratio	> 60 dB
Channels separation	> 50 dB (1 kHz)
Frequency response	20 Hz – 20 kHz

FM tuner

Frequency range	87,5–108 MHz
Tuning step	50 kHz
Sensitivity	2,8 μ V
Stereo reception separation	30 dB
Signal to noise ratio	45 dB

Line output

Output voltage	750 mV
Impedance	10 Kohms

Auxiliary input (AUX-IN)

Frequency response	20 Hz – 20 kHz
Sensitivity	775 mV
Impedance	20 Kohms

General

Power supply	12 V DC (permitted range 10,8–15,6 V)
Speaker impedance	4 or 8 Ohm
Output power	4 × 40 W
Fuse	10 A

Note: Technical specifications and design may change without prior notice.

The original version is in Czech.

Manufacturer address: FAST ČR, a.s., Černokostelecká 1621, Říčany CZ-251 01.

INSTRUCTIONS AND INFORMATION REGARDING THE DISPOSAL OF USED PACKAGING MATERIALS

Dispose of packaging material at a public waste disposal site.



DISPOSAL OF USED ELECTRICAL AND ELECTRONIC APPLIANCES

The meaning of the symbol on the product, its accessory or packaging indicates that this product shall not be treated as household waste. Please, dispose of this product at your applicable collection point for the recycling of electrical & electronic equipment waste. Alternatively in some states of the European Union or other European states you may return your products to your local retailer when buying an equivalent new product.

The correct disposal of this product will help save valuable natural resources and help in preventing the potential negative impact on the environment and human health, which could be caused as a result of improper liquidation of waste. Please ask your local authorities or the nearest waste collection centre for further details. The improper disposal of this type of waste may fall subject to national regulations for fines.

For business entities in the European Union

If you wish to dispose of an electrical or electronic device, request the necessary information from your seller or supplier.

Disposal in other countries outside the European Union

If you wish to dispose of this product, request the necessary information about the correct disposal method from local government departments or from your seller.



This appliance complies with EU rules and regulations regarding electromagnetic and electrical safety.

Changes to the text, design and technical specifications may occur without prior notice and we reserve the right to make these changes.

SENCOR®

EN Warranty conditions

Warranty card is not a part of the device packaging.

This product is warranted for the period of 24 months from the date of purchase to the end-user. Warranty is limited to the following conditions. Warranty is referred only to the customer goods using for common domestic use. The claim for service can be applied either at dealer's shop where the product was bought, or at below mentioned authorized service shops. The end-user is obligated to set up a claim immediately when the defects appeared but only till the end of warranty period. The end user is obligated to cooperate to certify the claiming defects. Only completed and clean (according to hygienic standards) product will be accepted. In case of eligible warranty claim the warranty period will be prolonged by the period from the date of claim application till the date of taking over the product by end-user, or the date the end-user is obligated to take it over. To obtain the service under this warranty, end-user is obligated to certify his claim with duly completed following documents: receipt, certificate of warranty, certificate of installation.

This warranty is void especially if apply as follows:

- Defects which were put on sale.
- Wear-out or damage caused by common use.
- The product was damaged by unprofessional or wrong installation, used in contrary to the applicable instruction manual, used in contrary to legal enactment and common process of use or used for another purpose which has been designed for.
- The product was damaged by uncared-for or insufficient maintenance.
- The product was damaged by dirt, accident of force majeure (natural disaster, fire, and flood).
- Defects on functionality caused by low duality of signal, electromagnetic field interference etc.
- The product was mechanically damaged (e.g. broken button, fall).
- Damage caused by use of unsuitable media, fillings, expendable supplies (batteries) or by unsuitable working conditions (e.g. high temperatures, high humidity, quakes).
- Repair, modification or other failure action to the product by unauthorized person.
- End-user did not prove enough his right to claim (time and place of purchase).
- Data on presented documents differs from data on products.
- Cases when the claiming product cannot be indentified according to the presented documents (e.g. the serial number or the warranty seal has been damaged).

Authorized service centers

Visit www.sencor.eu for detailed information about authorized service centers.

SENCOR®

Let's live!



www.sencor.cz

Designed in Europe by Sencor®, Made in China

