

FM/AM Radio-Controlled Clock Radio

ICF-C275RC

Operating Instructions

DREAM MACHINE

Dream Machine is a trademark of Sony Corporation.



Printed on 100% recycled paper using VOC (Volatile Organic Compound)-free vegetable oil based ink.

© 2004 Sony Corporation

Printed in China

For customers who purchased this product in the USA
Please register this product on line at <http://www.sony.com/productregistration>. Proper registration will enable us to send you periodic mailings about new products, services, and other important announcements. Registering your product will also allow us to contact you in the unlikely event that the product needs adjustment or modification. Thank you.

WARNING

To prevent fire or shock hazard, do not expose the unit to rain or moisture.
To avoid electrical shock, do not open the cabinet. Refer servicing to qualified personnel only. Do not install the appliance in a confined space, such as a bookcase or built-in cabinet. To prevent fire or shock hazard, do not place objects filled with liquids, such as vases, on the apparatus.

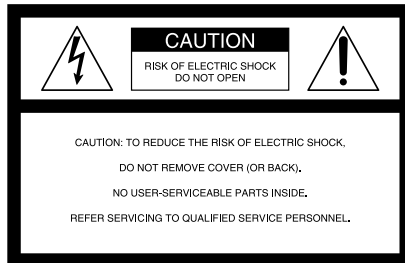

This symbol is intended to alert the user to the presence of uninsulated “dangerous voltage” within the product’s enclosure that may be of sufficient magnitude to constitute a risk of electric shock to persons.



This symbol is intended to alert the user to the presence of important operating and maintenance (servicing) instructions in the literature accompanying the appliance.

* The graphical symbols are at the bottom of the unit.

WARNING

You are cautioned that any changes or modifications not expressly approved in this manual could void your authority to operate this equipment.

INFORMATION

This equipment has been tested and found to comply with the limits for a Class B digital device, pursuant to Part 15 of the FCC Rules. These limits are designed to provide reasonable protection against harmful interference in a residential installation. This equipment generates, uses, and can radiate radio frequency energy and, if not installed and used in accordance with the instructions, may cause harmful interference to radio communications. However, there is no guarantee that interference will not occur in a particular installation. If this equipment does cause harmful interference to radio or television reception, which can be determined by turning the equipment off and on, the user is encouraged to try to correct the interference by one or more of the following measures:

- Reorient or relocate the receiving antenna.
- Increase the separation between the equipment and receiver.
- Connect the equipment into an outlet on a circuit different from that to which the receiver is connected.
- Consult the dealer or an experienced radio/TV technician for help.

Features

- Radio Controlled Clock Auto Adjust System.
- Dual alarm FM/AM PLL (phase locked loop) synthesized clock radio.
- Triple time display – main display for the clock, and two sub-displays for the alarms.
- Green backlight LCD with adjustable brightness.
- Date button to display the year, month and day.
- Easy preset digital tuning with 15 memory presets.
- D.S.T. (Daylight Saving Time) – Summer time adjustment (one-hour skip function).
- Various types of alarms-radio, buzzer and 2 melodies.
- Extendable snooze – snooze time can be extended from 10 to 60 minutes (maximum).
- Nap Timer allows you to take a short nap and wake to buzzer without changing your alarm settings. (You can select your nap time from 10 to 120 minutes)

Troubleshooting

Should any problem occur with the unit, make the following simple checks to determine whether or not servicing is required.

If the problem persists, consult your nearest Sony dealer.

Unable to receive time signals

- Inappropriate location for setting up antenna. Try moving the antenna to a different location. If reception is still bad, wait for awhile because reception may improve at a later time. See “Improving the Reception.”
- Has an electrical power outage lasting more than 1 minutes occurred?

The clock does not show the correct time.

- Has the desired radio or buzzer alarm been activated? (i.e. Is the display ALARM A or B turned on?)

The radio alarm is activated but no sound comes on at the preset alarm time.

- Has VOLUME been adjusted ?

Precautions

- Operate the unit only on 120 V AC, 60 Hz.
- To disconnect the power cord (mains lead), pull it out by the plug, not the cord.
- Do not leave the unit in a location near a heat source, such as a radiator or airduct, or in a place subject to direct sunlight, excessive dust, mechanical vibration, or shock.
- Allow adequate air circulation to prevent internal heat build-up. Do not place the unit on a surface (a rug, blanket, etc.) or near materials (a curtain) that might block the ventilation holes.
- Should any solid object or liquid fall into the unit, unplug the unit and have it checked by a qualified personnel before operating it any further.
- To clean the casing, use a soft cloth dampened with a mild detergent solution.

If you have any questions or problems concerning your unit, please consult your nearest Sony dealer.

Specifications

Time display

12-hour system

Frequency range

FM: 87.5–108 MHz
AM: 530–1 710 kHz

Channel steps

FM: 0.1 MHz (fixed)
AM: 10 kHz (fixed)

Speaker

Approx. 6.6 cm (2 5/8 in.) dia., 8 Ω

Power output

200 mW (at 10% harmonic distortion)

Power requirements

120 V AC, 60 Hz

Dimensions

Approx. 173 × 57.2 × 133.5 mm (w/h/d)
(6 7/8 × 2 3/8 × 5 3/8 in.) incl. projecting parts and controls

Mass

Approx. 630 g (1 lb. 6.2 oz.)

Design and specifications are subject to change without notice.



Lead-free solder is used for soldering. Halogenated flame retardants are not used in printed wiring boards.

IMPORTANT SAFEGUARDS

For your protection, please read these safety instructions completely before operating the appliance, and keep this manual for future reference.

Carefully observe all warnings, precautions and instructions on the appliance and in the operating instructions, and adhere to them.

INSTALLATION

Water and Moisture

Do not use powerline operated appliances near water - for example, near a bathtub, washbowl, kitchen sink, or laundry tub, in a wet basement, or near a swimming pool, etc.

Heat

Do not place the appliance near or over a radiator or heat register, or where it is exposed to direct sunlight.

Ventilation

The slots and openings in the cabinet are provided for necessary ventilation. To ensure reliable operation of the appliance, and to protect it from overheating, these slots and openings must never be blocked or covered.

-Never cover the slots and openings with a cloth or other materials.

-Never block the slots and openings by placing the appliance on a bed, sofa, rug or other similar surface.

-Never place the appliance in a confined space, such as a bookcase, or built-in cabinet, unless proper ventilation is provided.

Accessories

Do not place the appliance on an unstable cart, stand, tripod, bracket, or table. The appliance may fall, causing serious injury to a child or an adult, and serious damage to the appliance. Use only a cart, stand, tripod, bracket, or table recommended by Sony.

-An appliance and cart combination should be moved with care. Quick stops, excessive force, and uneven surfaces may cause the appliance and cart combination to overturn.

Wall or Ceiling Mounting

If your appliance can be mounted to a wall or ceiling, mount it only as recommended by Sony.

USE

Power Source

This appliance should be operated only from the type of power source indicated on the marking label. If you are not sure of the type of electrical power supplied to your home, consult your dealer or local power company. For those appliances designed to operate from battery power, or other sources, refer to the operating instructions.

Grounding or Polarization

This appliance is equipped with a polarized AC power cord plug (a plug having one blade wider than the other), or with a three-wire grounding type plug (a plug having a third pin for grounding). Follow the instructions below:

-For the appliance with a polarized AC power cord plug:

This plug will fit into the power outlet only one way. This is a safety feature. If you are unable to insert the plug fully into the outlet, try reversing the plug. If the plug should still fail to fit, contact your electrician to have a suitable outlet installed. Do not defeat the safety purpose of the polarized plug by forcing it in.

-For the appliance with a three-wire grounding type AC plug:

This plug will only fit into a grounding-type power outlet. This is a safety feature. If you are unable to insert the plug into the outlet, contact your electrician to have a suitable outlet installed. Do not defeat the safety purpose of the grounding plug.

Overloading

Do not overload wall outlets, extension cords or convenience receptacles beyond their capacity, since this can result in fire or electric shock.

When not in use

Unplug the power cord of the appliance from the outlet when left unused for a long period of time. To disconnect the cord, pull it out by grasping the plug. Never pull the plug out by the cord.

Power-Cord Protection

Route the power cord so that it is not likely to be walked on or pinched by items placed upon or against them, paying particular attention to the plugs, receptacles, and the point where the cord exits from the appliance.

Lightning

For added protection for this appliance during a lightning storm, or when it is left unattended and unused for long periods of time, unplug it from the wall outlet and disconnect the antenna or cable system. This will prevent damage to the appliance due to lightning and powerline surges.

Object and Liquid Entry

Never push objects of any kind into the appliance through openings as they may touch dangerous voltage points or short out parts that could result in a fire or electric shock. Never spill liquid of any kind on the appliance.

Cleaning

Unplug the appliance from the wall outlet before cleaning or polishing it. Do not use liquid cleaners or aerosol cleaners. Use a cloth lightly dampened with water for cleaning the exterior of the appliance. Clean the appliance only as recommended by Sony.

Attachments

Do not use attachments not recommended by Sony, as they may cause hazards.

ANTENNAS

Outdoor Antenna Grounding

If an outdoor antenna or cable system is installed, follow the precautions below.

An outdoor antenna system should not be located in the vicinity of overhead power lines or other electric light or power circuits, or where it can come in contact with such power lines or circuits. WHEN INSTALLING AN OUTDOOR ANTENNA SYSTEM, EXTREME CARE SHOULD BE TAKEN TO KEEP FROM CONTACTING SUCH POWER LINES OR CIRCUITS AS CONTACT WITH THEM IS ALMOST INVARIABLY FATAL.

Be sure the antenna system is grounded so as to provide some protection against voltage surges and built-up static charges. Section 810 of the National Electrical Code provides information with respect to proper grounding of the mast and supporting structure, grounding of the lead-in wire to an antenna discharge unit, size of grounding conductors, location of antenna-discharge unit, connection to grounding electrodes, and requirements for the grounding electrode.

Antenna Grounding According to the National Electrical Code

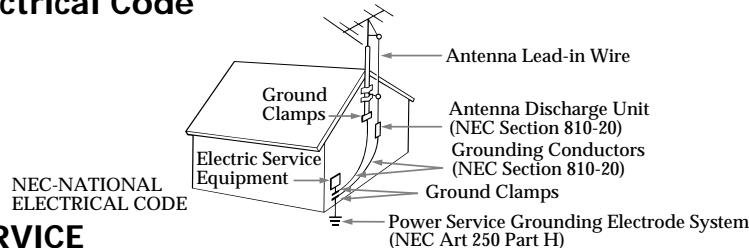

SERVICE

Damage Requiring Service

Unplug the appliance from the wall outlet and refer servicing to qualified service personnel under the following conditions:

- When the power cord or plug is damage or frayed.
- If liquid has been spilled or objects have fallen into the appliance.
- If the appliance has been exposed to rain or water.
- The appliance does not appear to operate normally or exhibits a marked change in performance.
- This indicates a need for service.
- If the appliance does not operate normally when following the operating instructions, adjust only those controls that are specified in the operating instructions. Improper adjustment of other controls may result in damage and will often require extensive work by a qualified technician to restore the appliance to normal operation.
- If the appliance has been subject to excessive shock by being dropped, or the cabinet has been damaged.

Servicing

Do not attempt to service the appliance yourself as opening or removing covers may expose you to dangerous voltage or other hazards.

Refer all servicing to qualified service personnel.

Replacement parts

When replacement parts are required, be sure the service technician has used replacement parts specified by Sony that have the same characteristics as the original parts.

Unauthorized substitutions may result in fire, electric shock, or other hazards.

Safety Check

Upon completion of any service or repairs to the appliance, ask the service technician to perform routine safety checks (as specified by Sony) to determine that the appliance is in safe operating condition.

<http://www.sony.net/>

SONY®

Tape Cassette Player/Recorder/CD Player/Mini Disc DAT/Radio/Head Phone/Speaker/MIC/Personals

Portable Audio

LIMITED WARRANTY

Sony Electronics Inc. (“Sony”) warrants this Product (including any accessories) against defects in material or workmanship as follows:

1. For a period of one (1) year from the date of purchase if this Product is determined to be defective, Sony will repair or replace the Product, at its option, at no charge. After this one (1) year period, you must pay for the replacement unit. This warranty does not cover costs incurred in connection with the removal and re-installation of radios, speakers or accessories, nor does it cover any other contingent expenses.

2. To obtain warranty service, you must take the Product, or deliver the Product freight prepaid, in either its original packaging or packaging affording an equal degree of protection, to any Factory Sony Service facility or to the Laredo Fulfillment Center. See below for additional information.

This warranty does not cover customer instruction, installation, set up adjustments or signal reception problems.

This warranty does not cover cosmetic damage or damage due to acts of God, accident, misuse, abuse, negligence, commercial use, or modification of, or to any part of the Product, including the antenna. This warranty does not cover damage due to improper operation or maintenance, connection to improper voltage supply, or attempted repair by anyone other than a facility authorized by Sony to service the Product. This warranty does not cover Products sold AS IS or WITH ALL FAULTS, or consumables (such as fuses or batteries). This warranty is valid only in the United States.

Proof of purchase in the form of a bill of sale or receipted invoice which is evidence that the unit is within the Warranty period must be presented to obtain warranty service.

This warranty is invalid if the factory applied serial number has been altered or removed from the Product.

REPAIR OR REPLACEMENT AS PROVIDED UNDER THIS WARRANTY IS THE EXCLUSIVE REMEDY OF THE CONSUMER. SONY SHALL NOT BE LIABLE FOR ANY INCIDENTAL OR CONSEQUENTIAL DAMAGES FOR BREACH OF ANY EXPRESS OR IMPLIED WARRANTY ON THIS PRODUCT, EXCEPT TO THE EXTENT PROHIBITED BY APPLICABLE LAW, ANY IMPLIED WARRANTY OF MERCHANTABILITY OR FITNESS FOR A PARTICULAR PURPOSE ON THIS PRODUCT IS LIMITED IN DURATION TO THE DURATION OF THIS WARRANTY.

Some states do not allow the exclusion or limitation of incidental or consequential damages, or allow limitations on how long an implied warranty lasts, so the above limitations or exclusions may not apply to you. In addition, if you enter into a service contract with the Sony Partnership within 90 days of the date of sale, the limitation on how long an implied warranty lasts does not apply to you. This warranty gives you specific legal rights, and you may have other rights which vary from state to state.

The Address of the Laredo Fulfillment Center is:

Laredo Fulfillment Center
10227 Crossroads Loop Suite B
Laredo, TX 78045

For your convenience, Sony Electronics Inc. has established telephone numbers for frequently asked questions:

To locate the servicer or dealer nearest you, or for service assistance or resolution of a service problem, or for product information or operation, call:

Sony Customer Information Services Center
1-800-222-7669
or visit the Sony Web Site:
www.sony.com

For an accessory or part not available from your authorized dealer, call:

1-800-488-SONY (7669)

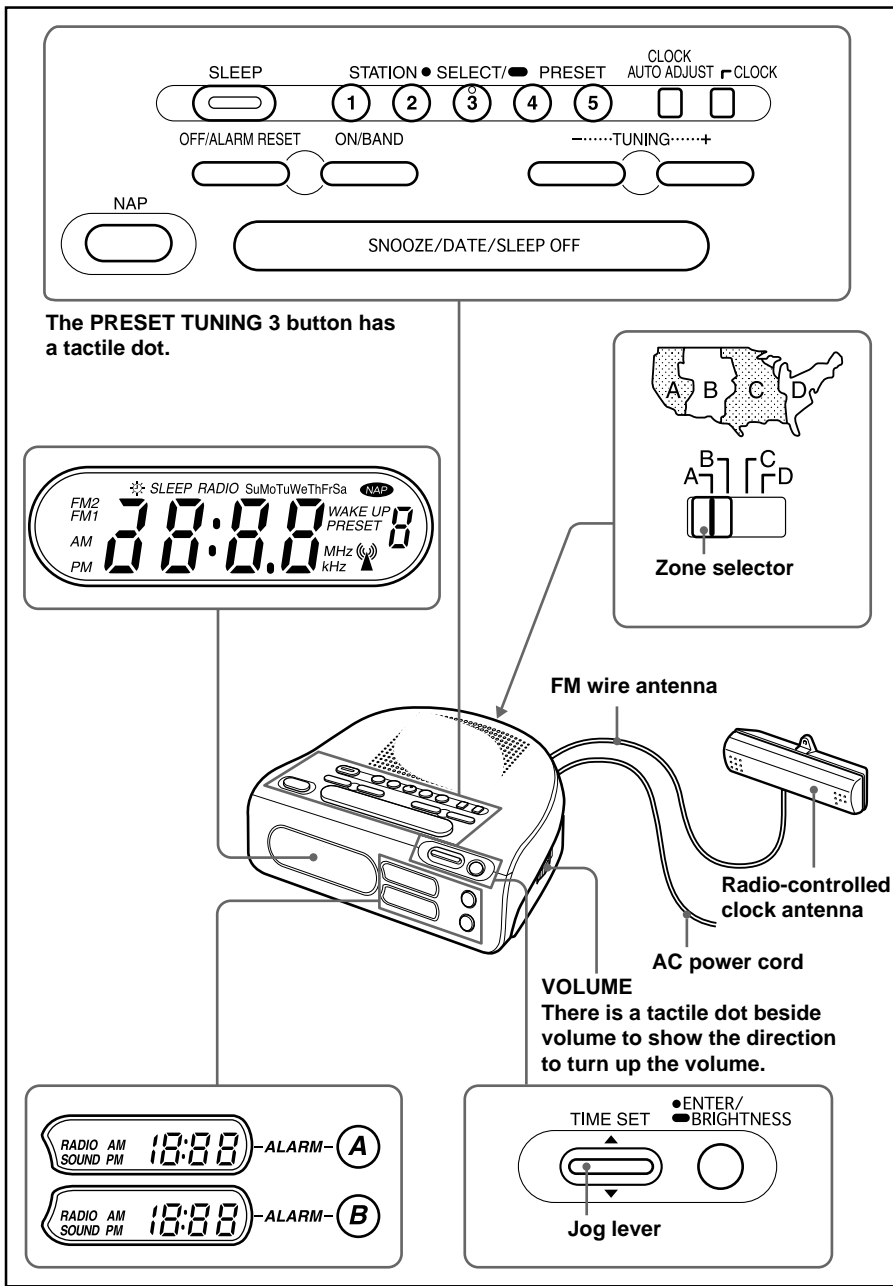

The PRESET TUNING 3 button has a tactile dot.

FM wire antenna

Radio-controlled clock antenna

AC power cord

VOLUME
There is a tactile dot beside volume to show the direction to turn up the volume.

TIME SET

ENTER/BRIGHTNESS

Jog lever

Setting the Clock and Date

When the unit is plugged in, “AM 12:00,” “We,” and “Lit” will flash in the display.

Note

If you cannot see the display clearly, press and hold **ENTER/BRIGHTNESS** to set the desired brightness (high, middle or low).

To Set the Clock and Date Automatically

This radio is equipped with a radio-controlled clock-auto-adjust system.

The clock-auto-adjust receives standard time data (year, month, day, hour, minute, second, and D.S.T.) on a prescribed frequency, and uses that to automatically reset the clock. To receive correct local time, set the zone selector (illustrated below) on the rear of the radio to the time zone you are in (Eastern, Central, Mountain, or Pacific). If the selector is set to the wrong zone, the displayed time will be wrong. There are no zone settings for Alaska and Hawaii.

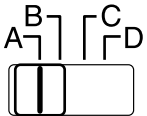

1 Plug in the unit.

The Clock Auto Adjust function activates automatically. “Lit” will flash in the display. It takes about three minutes from the moment that reception starts until the displayed time is correct even if the reception is good.

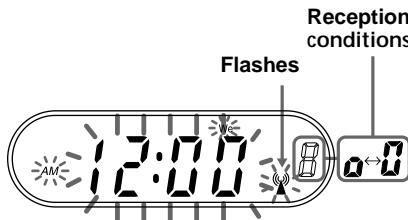

Reception conditions



Reception conditions

2 When clock adjustment is completed, the clock will start to operate. “Lit” will stop flashing and remain in the display.

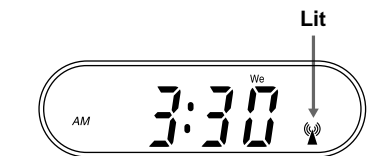

Notes

- If the radio is turned on before clock adjustment is completed, the unit stops receiving time signals.
- If **CLOCK AUTO ADJUST** is pressed before clock adjustment is completed, the unit stops receiving time signals.

Unable to set the Clock Automatically

Press **CLOCK** until you hear one beep and press Jog lever ▲ (up) or ▼ (down) to set the correct time and date. (See “To Set the Clock and Date Manually.”)

To initiate Clock Auto Adjust manually

Pressing **CLOCK AUTO ADJUST** allows you to receive time signals. “Lit” will flash in the display. When the Clock Auto Adjust process is completed, the clock will be corrected, if needed, and “Lit” will stop flashing and remain lit in the display. If the radio fails to receive time signals for about 12 minutes, the clock will remain unadjusted, and “Lit” will disappear from the display.

Notes

- The radio is being operated, the unit cannot receive time signals.
- If the radio is turned on while the Clock Auto Adjust system is activated, the unit stops receiving time signals.

To check reception

The display shows reception conditions when time signals are being received (when the power cord is inserted in a wall socket, or **CLOCK AUTO ADJUST** is pressed).

Display	Reception
Changes regularly between “a” and “b” at one second intervals	Good
“a” or “b” stays on, or intervals between changes are irregular	Defective

To improve reception

Reception is governed largely by where the radio-controlled clock antenna is set up and which direction it is pointed in.

Location of radio-controlled clock antenna setup:

If the installation is within a building made of reinforced concrete, reception will be weaker the farther the antenna is from a window. To improve reception, place the antenna as close as possible to the window.

Direction the antenna faces:

Reception changes depending on the direction that the antenna is facing. Look at the display window to check reception, and turn the antenna so that it faces in the direction where reception is most stable. Reception may be poor when the antenna is placed on a metal surface such as that of a steel desk.

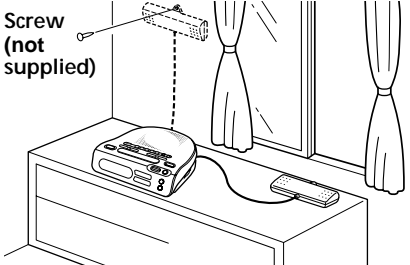

Notes

- Reception may be impossible in these locations:
 - Close to a television set, personal computer, refrigerator or similar electrical appliance or equipment.
 - Close to high voltage wires or overhead power lines.
 - Locations where there could be interference from electrical signals such as a construction site, airport or any other place where there is a large volume of traffic.

Location of transmitting source

Time signals are transmitted from the following location:

Fort Collins, Colorado, U.S.A.
40° 40' N, 105° 03' W

Time signal strength varies depending on the time of reception (you will get better reception at night). If the clock is not set or corrected automatically after you change the location or direction of the radio-controlled clock antenna, wait a while and see if you get better reception at a later time.

Automatic updating of time data

The Dream Machine is equipped with the Clock Auto Adjust system that automatically receives time signals during the night, when reception is best. The system makes nine corrections every hour from 8 p.m. to 4 a.m. During automatic operation, “Lit” does not flash. If the Clock Auto Adjust system is unable to receive time signals for more than 24 hours “Lit” goes off. In such a case, press **CLOCK AUTO ADJUST** to initiate Clock Auto Adjust manually and change the position or direction of the radio-controlled clock antenna for improved reception.

Note

Automatic updating cannot be manually cancelled.

On daylight Saving Time adjustment

The Clock Auto Adjust system automatically switches the clock indication to Daylight Saving Time (summer time), and back, at the necessary time of the year. “Lit” will be displayed when the clock is in Daylight Saving Time.

Note

According to reception conditions, the actual adjustment to or from Daylight Saving Time by the Clock Auto Adjust system may be done later than the exact moment of transition in the yearly calendar.

To Set the Clock and Date Manually

- Plug in the clock radio. The display will flash “AM 12:00”.
- Press **CLOCK** for a few seconds. You will hear a beep and the year will start to flash in the display.
- Press Jog lever ▲ (up) or ▼ (down) until the correct year appears in the display.
- Press **ENTER/BRIGHTNESS**.
- Repeat steps 3 and 4 to set the month, day, hour, and minute. After setting the minute, press **ENTER/BRIGHTNESS** to start the counting of the seconds, and you will hear two short beeps.

- To set the current time rapidly, hold down Jog lever ▲ (up) or ▼ (down).
- In step 5, when you press **ENTER/BRIGHTNESS** after the minute setting to activate the clock, the seconds start counting from zero.
- When the alarm setting mode is entered, the clock cannot be set.

Note

The clock is set to automatically receive time signals and will continue to do so even if it is manually reset.

To display the year and date

Press **SNOOZE/DATE/SLEEP OFF** once for the date, and within 2 seconds press it again for the year. The display shows the date or year for a few seconds and then changes back to the current time.

To set the brightness of the backlight

If you cannot see the display clearly, press and hold **ENTER/BRIGHTNESS** to set the desired brightness (high, middle or low).

Changing AM Channel Step

The AM channel step differs depending on area. The channel step of this unit is factory-set to 10 kHz to change the setting as shown below to be able to listen to the radio.

Area	Channel step
North and South America	10 kHz
Other countries/regions	9 kHz

- Plug in the clock radio. Press **OFF/ALARM RESET** to turn off the power.
- While holding down **OFF/ALARM RESET**, keep pressing **ON/BAND** for more than 5 seconds. The AM channel step will be changed. If you proceed to step 2 again, the channel step changes again.

Notes

- When the AM channel step is changed, the preset stations for AM will be initialized.
- When the AM channel step is changed, the FM channel step also will be changed.

Playing the Radio —Manual Tuning

- Press **ON/BAND** to turn on the radio. The display shows the band and frequency for a few seconds and then changes back to the current time.
- Press **ON/BAND** repeatedly to select the desired band. Each press changes the band as follows:

→ AM → FM1 → FM2

When using FM1 or FM2 preset mode, you may listen to the radio on either mode. (See “Presetting Your Favourite Station”.)
- Use **TUNING +** or **–** to tune into the desired station. The FM frequency advances or reverses in 0.1 MHz channel steps and the AM frequency in 10 kHz channel steps. Two short beeps sound when the minimum frequency of each band is received during tuning.
- Adjust volume using **VOLUME**.

- To turn off the radio, press **OFF/ALARM RESET**.
- To check the station being received, press **TUNING +** or **–** or **ON/BAND** lightly. The display shows the band and frequency for a few seconds and then changes back to the current time.

Improving the Reception

- FM:** Extend the FM wire antenna fully to increase reception sensitivity.
- AM:** Rotate the unit horizontally for optimum reception. A ferrite bar is built in to the unit.

Do not operate the unit over a steel desk or metal surface, as this may lead to interference of reception.

Presetting Your Favourite Station

—Preset Tuning

You can preset up to 10 stations in FM (5 stations in FM1, 5 stations in FM2), and 5 stations in AM.

Presetting a Station

- Follow steps 1 to 4 in “Playing the Radio” and manually tune into the station you wish to preset.

- Hold down the desired **STATION•SELECT/PRESET** button until you hear two short beeps.

Example: To preset AM 1 260 kHz onto preset 2 button.



The display shows the frequency for a few seconds and then changes back to the current time.

To preset another station, repeat these steps.

To change the preset station, tune in to the desired station and hold down the **PRESET TUNING 1 to 5** button. The new station will replace the previous station on the preset button.

Tuning into a preset station

- Press **ON/BAND** to turn on the radio.
- Press **STATION•SELECT/PRESET** where the desired station is stored.
- Adjust volume using **VOLUME**. After a few seconds, the display will return to the current time but the preset button number will remain.

Setting the Alarm

You can choose from two types of alarm, Radio or Buzzer.

The alarm will come on at the same time everyday. The factory setting alarm time for the radio and buzzer is 12:00am.

Notes

- Set the current time before setting the alarm.
- Radio reception is interrupted while the alarm time is being set.

To set the Alarm Time

- Press and hold **ALARM A** or **ALARM B** for a few seconds. After one beep, the hour flashes in the alarm display.
- Press Jog lever ▲ (up) or ▼ (down) to select the hour. To set the hour rapidly, hold down Jog lever ▲ (up) or ▼ (down).
- Press **ENTER/BRIGHTNESS**. After one beep, the minutes flash on the alarm display.
- Repeat steps 2 and 3 to set the minute. A beep sounds to confirm the time setting. “RADIO•SOUND” appears. You can choose between “RADIO” and “SOUND” modes. Set the alarm mode as follows:
 - RADIO: see “**A** Setting the Radio Alarm”
 - SOUND: see “**B** Setting the Sound Alarm”

A Setting the Radio Alarm

For the radio alarm, the station you specified as the wake-up station is played.

- Perform steps 1 to 4 in “To set the Alarm Time.”
- Press Jog lever ▲ (up) or ▼ (down) to select “RADIO” alarm mode. “WAKE UP STATION” appears in the display.
- Press **ENTER/BRIGHTNESS**. After one beep, the preset number flashes in the display.
- Press Jog lever ▲ (up) or ▼ (down) to select the desired wake-up station. Preset number changes in the order as follows:

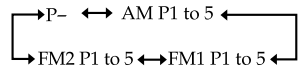

“P-” is the last received station.

You can directly select the desired wake-up station by pressing **ON/BAND** or the **STATION•SELCE/T/PRESET** button while the indication “P-” is not displayed.

- Press **ENTER/BRIGHTNESS**. Two short beeps will confirm the setting, and the ALARM A or B display will disappear.

B Setting the Sound Alarm

For the sound alarm, the sound you specified as the wake-up sound is played.

- Perform steps 1 to 4 in “To set the Alarm Time.”
- Press Jog lever ▲ (up) or ▼ (down) to select “SOUND” alarm mode. “WAKE UP SOUND” appears in the display.
- Press **ENTER/BRIGHTNESS**. The displayed wake-up sound number will sound.

- Press Jog lever ▲ (up) or ▼ (down) to select the desired wake-up sound.

- Buzzer
- “Four seasons: Spring” Antonio Lucio Vivaldi
- “For Eliza” Ludwig van Beethoven

- Press **ENTER/BRIGHTNESS**.

Two short beeps will confirm the setting, and the ALARM A or B display will disappear.

To Use the Radio and Buzzer Alarm

- Set both alarm times for ALARM A or B. (see above).
- Press **ALARM A** or **ALARM B**. The ALARM A or B display will be turned on.

If the same alarm time is set for both Alarm A and B, Alarm A takes priority.

To Doze for a Few More Minutes

Press **SNOOZE/DATE/SLEEP OFF**.

The radio or buzzer turns off but will automatically come on again after about 10 minutes. Every time you press **SNOOZE/DATE/SLEEP OFF**, the snooze time changes as follows:

10 → 20 → 30 → 40 → 50 → 60

The display shows the snooze time for a few seconds and returns to show the current time. When you press **SNOOZE/DATE/SLEEP OFF** after the current time appeared, the snooze time starts from 10 minutes again.

The maximum length of the snooze time is 60 minutes.

To Stop the Alarm

Press **OFF/ALARM RESET** to turn off the alarm.

The alarm will come on again at the same time the next day.

To Deactivate the Alarm

Press **ALARM A** or **ALARM B**.

The ALARM A or B display turns off.

Using the NAP Timer (Count Down Timer)

The NAP timer sounds the buzzer after a preset time duration. Press **NAP** repeatedly until the desired minutes are displayed. Every press changes the display as follows:

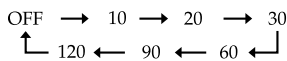

You will hear two beeps when the display turns from “OFF” to “10”. “NAP” appears and the NAP time is displayed for a few seconds. NAP timer starts counting down the NAP time. When selected NAP time has passed, the beep sound comes on, and “NAP” flashes on the display. The buzzer is turned off automatically after about 60 minutes.

To Stop the NAP Timer

Press **NAP** or **OFF/ALARM RESET** to turn off the buzzer.

To Deactive the NAP Timer

Press **NAP**.

“NAP” go off in the display.

Setting the Sleep Timer

You can fall asleep to the radio using the built-in sleep timer that turns off the radio automatically after a preset duration.

Press **SLEEP**.

The radio turns on. You can set the sleep timer to durations of 90, 60, 30, or 15 minutes. Every push changes the display as follows:

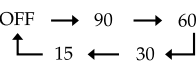

You will hear two beeps when the display turns from “OFF” to “90”. “SLEEP” will appear in the display when the duration time is set. The radio will play for the duration you set, then shut off.

- To turn off the radio before the preset time, press **SNOOZE/DATE/SLEEP OFF**.

To Use Both Sleep Timer and Alarm

You can fall asleep to the radio and also be awakened by the radio or buzzer alarm at a preset time.

- Set the alarm. (See “Setting the Alarm”.)
- Set the sleep timer. (See “Setting the Sleep Timer”.)